

LABOR AND MATERIALS

1	Copper Lead	Connection	3/4"	\$
1	Curb	Cock Valve	3/4 in.	\$
1	Service box	} Short 3 1/2 x 4 1/2 Long 4 1/2 x 5 1/2 Buff or Rdway		\$
	Old returned			\$
8	Ft.	Copper	} Pipe at	\$
	3/4 in.	G. I.		
		C. I.		
	Nipples	in. at		\$
	Bushings	to in. at		\$
	Red'g	} Coupl'gs	to in. at	\$
	Inc'g			
	Union	in. at		\$
	Meter	in. at		\$
	Lead Joints	at		\$
	Compound Joints	at		\$
	Maintenance Foreman			\$
	Hrs. Water Maint. Man-1	at		\$
	Hrs. Water Maint. Man-2	at		\$
	Hrs. Garage Foreman	at		\$
	Hrs. Labor	at		\$
	Hrs. Compressor	at		\$
	Compensation Ins.	at \$ per C		\$
	Trucking			\$
	Pay't Patch			\$
	Tap by Gifford & Co. 7-1-57			\$
	O'head			\$

Maple St. Ave. No. 218

Name of Owner Dennis Hannan

Labor and Mat'l. Report July 1 1957

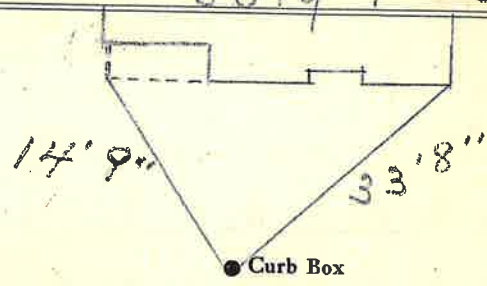

6" Main Elev. of Main at tap 7'

Gate at • • Gate at

• Curb Box