

LABOR AND MATERIALS

1	Copper Lead	} Connection	3/4	\$ 2.80
1	Curb	} Clock Valve (T. S. & V.)	3/8 in.	\$ 3.60
1	Service box Old returned	} Short 3 1/2 X 4 1/2 Long 4 1/2 X 5 1/2 Buffer Rdway		\$ 5.80
9	Ft.		3/4 in.	\$ 31.50
		Copper Galv. Iron Cast Iron	Pipe at	35
	Nipples	in. at		\$
	Bushings	to in. at		\$
	Red'g Inc'g	Couplings	to in. at	\$
	Union	in. at		\$
	Meter	in. at		\$
	Lead Joints at			\$
	Compound Joints at			\$
2	Hrs. Foreman at			\$ 2.02
1	Hrs. Chauffeur at			\$ 1.91
	Hrs. Tapper at			\$
13	Hrs. Labor at			\$ 10.40
	Hrs. Labor at			\$
	Hrs. Compressor at			\$
	Compensation Ins.			\$ 29
	Trucking			\$ 1.17
	Builders Use of Water			\$
	<i>Tap by Miller</i>			\$
				\$
				\$
				\$
				\$
				\$
				\$ 29.97

67-47

St.
Pl.

Mason

Ave. No. *15*

Name of Owner

Bennett

Labor and Mat'l. Report

July 26 1917

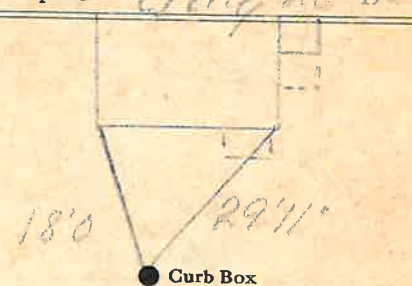

Main

Elev. of
Main at tap *4 1/2*

Gate at ●

● Gate at

● Curb Box