

LABOR AND MATERIALS

	Copper	Connection	3/4		\$ 2.80	
	Lead					
	Curb	Clock Valve T. S. & V.	3/4	in.	\$ 3.60	
	Service box Old returned	Short 3 1/2 X 4 1/2 Long 4 1/2 X 5 1/2 Buff or Rdway			\$ 5.80	
2	Ft.	3/4	in.	Copper Galv. Iron Cast Iron	Pipe at \$ 2.80	
	Nipples		in.	at	\$	
	Bushings		to	in.	at \$	
	Red'g Inc'g	Couplings		to	in.	at \$
	Union		in.	at	\$	
	Meter		in.	at	\$	
	Lead Joints			at	\$	
	Compound Joints			at	\$	
2	Hrs. Foreman				\$ 2.02	
1	Hrs. Chauffeur				\$ 91	
	Hrs. Tapper				\$	
13	Hrs. Labor				\$ 10.40	
	Hrs. Labor				\$	
	Hrs. Compressor				\$	
	Compensation Ins.				\$ 29	
	Trucking				\$ 1.00	
	Builders Use of Water				\$	
	Top 4 Mill				\$	
					\$	
					\$	
					\$	
					\$	
					\$ 29.62	

64-47

St.
Pl.
Ave. No. 17

Mason

Name of Owner

Pickens

Laboꝛ and Mat'l. Report July 28 19 27

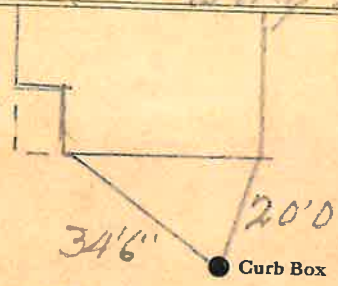

Main Elev. of
Main at tap 4 1/2

Gate at ● ● Gate at

● Curb Box