

LABOR AND MATERIALS

1	Copper Lead	Connection	3/4	in.	\$ 2.80
1	Curb Clock Valve	T. S. & V.	3/4	in.	\$ 3.60
1	Service box Old returned	Short 3/4 X 4 1/2			\$ 5.80
		Long 4 1/2 X 5 1/2			\$ 7.00
		Buff or Rdway			\$ 35
		Pipe at			\$ 7.00
		Copper Galv. Iron Cast Iron			\$
	20 Ft.	3/4	in.		\$
	Nipples	in. at		in. at	\$
	Bushings	to		in. at	\$
	Red'g Inc'g	Couplings	to	in. at	\$
	Union	in. at			\$
	Meter	in. at			\$ 2.02
	Lead Joints at				\$ 1.82
	Compound Joints at				\$ 12.00
2	Hrs. Foreman at				\$
2	Hrs. Chauffeur at				\$
15	Hrs. Labor at				\$ 35
	Hrs. Labor at				\$ 1.11
	Hrs. Compressor at				\$
	Compensation Ins.				\$
	Trucking				\$
	Builders Use of Water				\$
	Truck by Miller				\$ 36.39

72/47

St. Mason
Pl. Ave. No. 22

Name of Owner
Hogom

Labor and Mat'l. Report July 28 1907

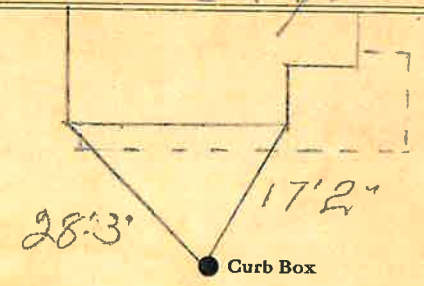

4 Main Elev. of Main at tap 4 1/2
Gate at ● Gate at ●

● Curb Box

Tax ID# 302.12-116-17