

LABOR AND MATERIALS

| | | | | | |
|-------|-----------------------|-----------------------|--|---------|----|
| 1 | Copper Lead | Connection | $\frac{3}{4}$ " | | \$ |
| 1 | Curb | Cock Valve T. S. & V. | $\frac{3}{4}$ in. | | \$ |
| 1 | Service Box | Old returned | Short $3\frac{1}{2} \times 4\frac{1}{2}$ | | \$ |
| | | | Long $4\frac{1}{2} \times 5\frac{1}{2}$ | | |
| 11-12 | $\frac{3}{4}$ Ft. | | Buff. or Rdway | | \$ |
| | | | Copper | Pipe at | \$ |
| | | | Galv. Iron | | |
| | | | Cast Iron | | |
| | Nipples | in. at | | | \$ |
| | Bushings | to | in. at | | \$ |
| 1 | Red'g Inc'g | Couplings | $\frac{3}{4}$ to $\frac{3}{4}$ in. | at | \$ |
| | | | | | \$ |
| | Union | in. at | | | \$ |
| | Meter | in. at | | | \$ |
| | Lead Joints | at | | | \$ |
| | Leadite Joints | at | | | \$ |
| | Hrs. Foreman | at | | | \$ |
| | Hrs. Chauffeur | at | | | \$ |
| | Hrs. Tapper | at | | | \$ |
| | Hrs. Labor | at | | | \$ |
| | Hrs. Labor | at | | | \$ |
| | Hrs. Compressor | at | | | \$ |
| | Compensation Ins. | | | | \$ |
| | Trucking | | | | \$ |
| | Builders Use of Water | | | | \$ |
| | | | | | \$ |
| | | | | | \$ |
| | | | | | \$ |

St. 5
Pl. 12
Ave. No. 12

Name of Owner _____

Labor and Mat'l. Report 19

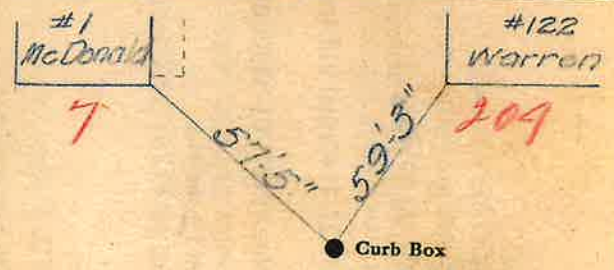

Elev. of Main at tap 6'
Main McDonald 5'

Gate at ● ● Gate at

● Curb Box

Vacant Lot

See also card for rear
of 122 Warren St.
204