

LABOR AND MATERIALS

1 Copper } Connection 3/4" \$ _____
 1 Lead }
 1 Curb } Cock } 3/4 in. \$ _____
 } Valve }
 } T. S. & V. }
 1 Service box { Short 3 1/2 x 4 1/2 }
 Old returned { Long 4 1/2 x 5 1/2 } \$ _____
 { Buff or Rdway }
38 Ft. 3/4 in. { Copper } Pipe at \$ _____
 { C. I. }
 { C. I. }
 Nipples _____ in. at \$ _____
 Bushings _____ to _____ in. at \$ _____
 Red'g }
 Inc'g } Coupl'gs _____ to _____ in. at \$ _____
 Union _____ in. at \$ _____
 Meter _____ in. at \$ _____
 Lead Joints at \$ _____
 Compound Joints at \$ _____
 Maintenance Foreman \$ _____
 Hrs. Water Maint. Man—1 at \$ _____
 Hrs. Water Maint. Man—2 at \$ _____
 Hrs. Garage Foreman _____ at \$ _____
 Hrs. Labor— _____ at \$ _____
 Hrs. Compressor at \$ _____
 Compensation Ins. at \$ _____ per C. \$ _____
 Trucking \$ _____
 Pav't Patch \$ _____
Tap by Gifford & Lar. S.V. \$ _____
6-28-67. \$ _____
 O'head \$ _____

St. 22
 Pl. 24
 Ave. No. 24

Name of Owner O'Conner.

Labor and Mat'l. Report June 28 19 67.

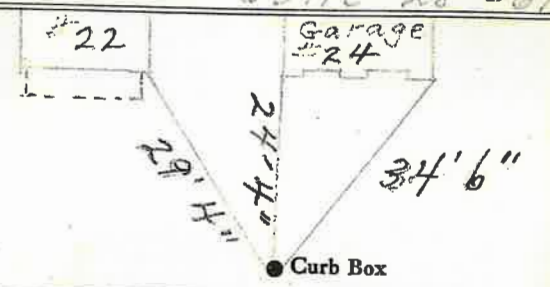

8" Main Elev. of Main at tap 5'
 Gate at ● Gate at ●

● Curb Box
 ALSO Feeds #22
 McDonald St.
 #22 - TAX ID # 303.18-11-14.2
 #24 - TAX ID # 303.18-11-13

