

**Labor and Materials**

Copper } Connection.....	\$ 96.
Lead } .....	
Curb { Cock } .....	\$ 1.33
{ Valve } .....	
{ T.S.&V. } .....	
Service Box { Short 3 1/2 x 1 1/2 } .....	\$ 1.35
Old returned { Long 4 1/2 x 5 1/2 } .....	
{ Bolt or Rivet } .....	
8 Ft. 3/4 in. { Copper } Pipe at 15.....	\$ 1.20
{ Galv. Iron } .....	
{ Cast Iron } .....	
Nipples ..... in. at .....	\$ .....
Bushings ..... to ..... in. at .....	\$ .....
Red'g } Couplings..... to ..... in. at .....	\$ .....
Inc'g } .....	
Union..... in. at .....	\$ .....
Meter..... in. at .....	\$ .....
Lbs. Br. Stone at .....	\$ .....
Lbs. Sand at .....	\$ .....
Bags Cement at .....	\$ .....
Paving Brick { Mack } at .....	\$ .....
{ Red } .....	
{ Asphalt } .....	
Lead Joints at .....	\$ .....
Leadite Joints at .....	\$ .....
6 Hrs. <sup>Chief</sup> Foreman at 6 1/2 hr.....	\$ 3.75
17 Hrs. Common Labor at 45.....	\$ 7.65
Hrs. Common Labor at .....	\$ .....
Hrs. Mason at .....	\$ .....
Hrs. Masons Helper at .....	\$ .....
Hrs. Compressor at .....	\$ .....
Compensation Ins .....	\$ 35
Trucking .....	\$ 1.00
Builders Use of Water <sup>hopatch</sup> .....	\$ .....
Total \$ 17.59	

33  
Labor and Material Report Aug. 3 1936

23 In Donald St.

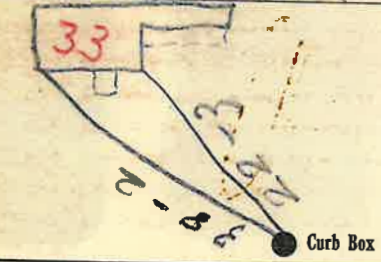

8-1975

Main

Elev of Main at tap 6

Gate at ●

● Gate at

● Curb Box

old shut off at drain

116

TAX ID # 303.18-6-17