

Labor and Materials

1	Copper } Connection	3/4"	\$ 3.20
	Lead		
1	Curb { Cock	3/4" in.	\$ 1.00
	Valve		
	T. S. & V.		
1	Service Box { Short 3/4 x 4 1/2		\$ 1.40
	Old returned { Long 4 1/2 x 5 1/2		
		Buff. or Rdway	
10	Pt. 3/4 in. { Copper		\$ 2.20
		Galv. Iron	
		Cast Iron	
		Pipe at	
	Nipples	in. at	\$
1	Bushings	3/4" to 1/2" in. at	\$ 8
1	Red'g } Couplings	3/4" to 1/2" in. at	\$ 15
	Iron		
	Union	in. at	\$
	Meter	in. at	\$
	Lbs Br. Stone at		\$
	Lbs. Sand at		\$
	Bags Cement at		\$
	Paving Brick { Mack		\$
		Red	
		Asphalt	
	Lead Joints at		\$
	Leadite Joints at		\$
	Hrs. Foreman at		\$
1.6	Hrs. Common Labor at	5.0	\$ 8.00
	Hrs. Common Labor at		\$
	Hrs. Mason at		\$
	Hrs. Mason's Helper at		\$
	Hrs. Compressor at		\$
	Compensation Ins.		\$ 22
	Trucking		\$ 1.00
	Builders' Use of Water		\$
Total \$			17.25

43

Labor and Material Report

19 36

Sept 2

3/4" tap at 81 Mc Donald St

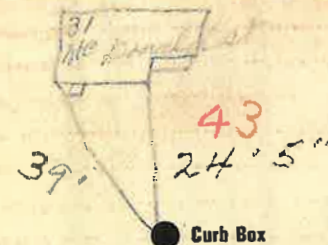

8-1975

X" Main

Elev. of Main at tap

Gate at ●

● Gate at

TAX ID # 303.18-6-13

● Curb Box