

LABOR AND MATERIALS

1	Copper Lead	Connection	<i>3/4</i>	\$	2.80	
1	Curb	Cock Valve T. S. & V.	<i>3/4</i>	in.	\$	3.60	
1	Service box Old returned	{ Short $3\frac{1}{2} \times 4\frac{1}{2}$ Long $4\frac{1}{2} \times 5\frac{1}{2}$ Buff or Rdway }			\$	5.80	
<i>25</i>	Ft.	Copper G. I. G. I.	<i>3/4</i>	in.	Pipe at	<i>35</i> \$ 9.80	
	Nipples	in.		at	\$		
	Bushings	to		in.	at	\$	
	Red'g						
	Inc'g	Coupl'gs		to	in.	at	\$
	Union	in.		at	\$		
	Meter	in.		at	\$		
	Lead Joints				\$		
	Compound Joints				\$		
	Hrs. Water Maint. Man-1	at			\$		
<i>16</i>	Hrs. Water Maint. Man-2	at	<i>91</i>		\$	<i>14.56</i>	
<i>16</i>	Hrs. Labor-	at	<i>80</i>		\$	<i>12.80</i>	
	Hrs. Labor-	at			\$		
	Hrs. Compressor	at			\$		
	Compensation Ins.	at \$		per C	\$	<i>60</i>	
	Trucking				\$	<i>1-</i>	
	Pav't Patch				\$		
	<i>T. J. Maksinski</i>					\$	<i>10.50</i>
	O'head				\$		
					\$	<i>61.46</i>	

99-17

St.
Pl.
Ave. No. *82*

McDonald

Name of Owner
Casey

Labor and Mat'l. Report *Aug 21* 19*47*

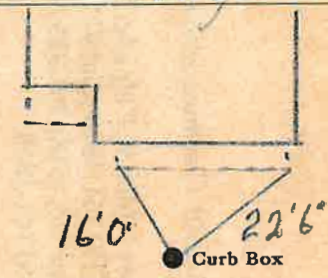

8-1975
X

Elev. of
Main at tap *5*

Gate at ● ● Gate at

TAX ID # 303.13-22-4

● Curb Box