

Labor and Materials

1	Copper } Connection		\$ 3.20
	Lead }		
1	Curb { Cock } 3/4 in.		\$ 1.00
	Valve } T. S. & V.		
1	Service Box { Short 3 1/2 x 4 1/2 } Old returned { Long 4 1/2 x 5 1/2 } Buff. or Rdway		\$ 1.20
40	Ft. 3/4 in. { Copper } Pipe at		\$ 9.02
		{ Galv. Iron } { Cast Iron }	
	Nipples	in. at	\$
1	Bushings	3/4" to 1/2" in. at	\$.08
2	Red'g } Couplings 3/4" to 1/2" in. at		\$.15
	Inc'g }		
	Union	in. at	\$
	Meter	in. at	\$
	Lbs. Br. Stone at		\$
	Lbs. Sand at		\$
	Bags Cement at		\$
	Paving Brick { Mack } at		\$
		{ Red } { Asphalt }	
	Lead Joints at		\$
	Leadite Joints at		\$
2	Hrs. Foreman at	6.25	\$ 1.25
7	Hrs. Common Labor at	5.0	\$ 2.50
20	Hrs. Common Labor at	4.25	\$ 8.50
	Hrs. Mason at		\$
	Hrs. Mason's Helper at		\$
	Hrs. Compressor at		\$
	Compensation Ins.		\$ 2.2
	Trucking		\$ 1.00
	Builders' Use of Water		\$
Total			\$ 28.95

Labor and Material Report

19

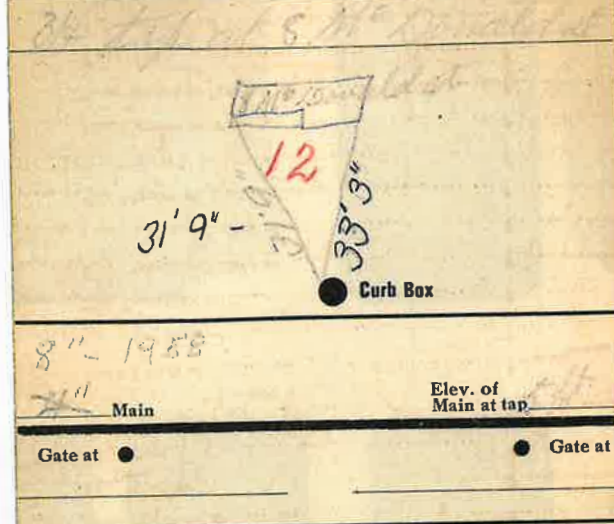

TAX ID # 303.18-11-3

NOTE: REVERSE
CURB BOX - ON IS OFF