

### Labor and Materials

1	Copper } Connection $\frac{3}{4}$ "	\$ 3.20
	Lead } .....	
1	Curb } Cock } $\frac{3}{4}$ " in.	\$ 1.00
	} T.S. & V. } .....	
1	Service Box } Short 3" x 4"	\$ 1.00
	Old returned } Long 4" x 5" Buff. or Redway }	
15'	3/4" in. } Copper } Pipe at.	\$ 3.20
	} Galv. Iron }	
	} Cast Iron }	
	Nipples..... in. at.....	\$ .....
	Bushings..... to..... in. at.....	\$ .....
	Red'g } Couplings..... to..... in. at.....	\$ .....
	Inc'g } .....	
	Union..... in. at.....	\$ .....
	Meter..... in. at.....	\$ .....
	Lbs. Br. Stone at.....	\$ .....
	Lbs. Sand at.....	\$ .....
	Bags Cement at.....	\$ .....
	Paving Brick } Mack } at.....	\$ .....
	} Red }	
	} Asphalt }	
	Lead Joints at.....	\$ .....
	Leadite Joints at.....	\$ .....
1	Hrs. Foreman at..... 62.4	\$ 6.3
4	Hrs. Common Labor at..... 50	\$ 2.00
9	Hrs. Common Labor at..... 20.5	\$ 3.66
	Hrs. Mason at.....	\$ .....
	Hrs. Mason's Helper at.....	\$ .....
	Hrs. Compressor at.....	\$ .....
	Compensation Ins.....	\$ 18.
	Trucking.....	\$ 1.20
	Builders' Use of Water.....	\$ .....
Total		\$ 16.27

### Labor and Material Report

43 Sept 1 19 59

Vacant lot 2nd Madison

TAP TO VACANT

LOT 2nd Madison

43

23 Madison

4041

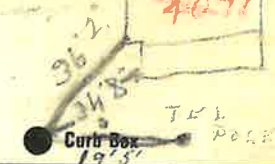

4" Main

Elev. of Main at tap

Gate at ●

● Gate at

● Curb Box

Alex Morency

Barrist

This Tap leaking  
shut off at main  
Sept. 23-59