

Mohican

St. # Ave. No.

Name of Owner Murry St Playground

City of Glens Falls

Labor and Mat'l. Report Oct 27 1973

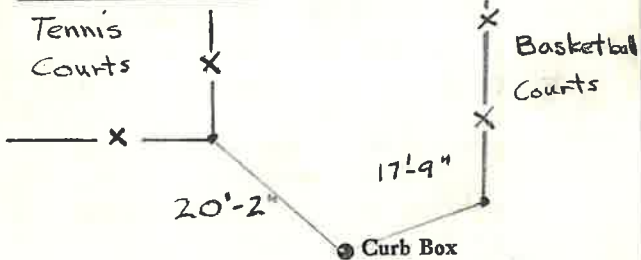

6 Main

Elev. of Main at tap 5'

Gate at •

• Gate at

• Curb Box

Murry St. Playground

Mohican

St. # Ave. No. ?

Name of Owner

City of Glens Falls - Rec. Comm.

Labor and Mat'l. Report Oct. 27 1973

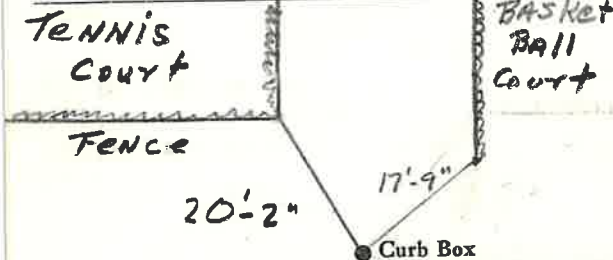

6" Main

Elev. of Main at tap 5'

Gate at •

• Gate at

Tax ID# 309.12-4-3

• Curb Box

TAP ON MOHICAN ST  
USE LONG WRENCH

Remeasured Jan 1975

LABOR AND MATERIALS

1 Copper } Connection 1/2" \$  
 Lead }  
 1 Curb } Cock } 2 in. \$  
           } Valve }  
           } F.S. & V. }  
 Service box { Short 3 1/2 x 4 1/2 }  
 Old returned { Long 4 1/2 x 5 1/2 } \$  
                   { Buff or Rdway }  
 20 Ft. 1/2 in. { Copper } Pipe at \$  
                   { G. I. }  
                   { C. I. }  
 Nipples in. at \$  
 1 Bushings 1/2" to 2" in. at \$  
 Red'g }  
 Inc'g } Coupl'gs to in. at \$  
 Union in. at \$  
 Meter in. at \$  
 Lead Joints at \$  
 Compound Joints at \$  
 Maintenance Foreman \$  
 Hrs. Water Maint. Man-1 at \$  
 Hrs. Water Maint. Man-2 at \$  
 Hrs. Garage Foreman at \$  
 Hrs. Labor at \$  
 Hrs. Compressor at \$  
 Compensation Ins. at \$ per C \$  
 Trucking \$  
 Pav't Patch \$  
 \$  
 \$  
 \$  
 \$  
 O'head \$  
 \$

LABOR AND MATERIALS

1 Copper } Connection 1 1/2" \$  
 Lead }  
 1 Curb } Cock } 2 in. ORISEAL \$  
           } Valve } IRON TO IRON  
           } F.S. & V. }  
 Service box { Short 3 1/2 x 4 1/2 }  
 Old returned { Long 4 1/2 x 5 1/2 } ORISEAL \$  
                   { Buff or Rdway }  
 20 Ft. 1/2 in. { Copper } Pipe at \$  
                   { G. I. } 4'-5'  
                   { C. I. }  
 Nipples in. at \$  
 1 Bushings 2" to 1 1/2 in. at BYSS \$  
 Red'g }  
 Inc'g } Coupl'gs to in. at \$  
 Union in. at \$  
 Meter in. at \$  
 1 Lead Joints at 1 1/2" Male Adapter \$  
 Compound Joints at \$  
 Maintenance Foreman \$  
 Hrs. Water Maint. Man-1 at \$  
 Hrs. Water Maint. Man-2 at \$  
 Hrs. Garage Foreman at \$  
 Hrs. Labor at \$  
 Hrs. Compressor at \$  
 Compensation Ins. at \$ per C \$  
 Trucking \$  
 Pav't Patch \$  
 \$  
 \$  
 \$  
 \$  
 Tap Made By Beecher  
 to O'head Oct 27-1973 \$  
 \$