

LABOR AND MATERIALS

1	Copper Lead	Connection	3/4"		\$	
1	Curb	Cock Valve	3/4 in.		\$	
		T.S. & V.				
1	Service box	}	Short 3 1/2 x 4 1/2		\$	
	Old returned		Long 4 1/2 x 5 1/2			
			Buff or Rdway			
9	3/4 in.	Copper	}	Pipe at	\$	
		G.I.				
		C.I.				
	Nipples	in. at			\$	
	Bushings	to	in. at		\$	
	Red'g Inc'g	Coupl'gs	to	in. at	\$	
	Union		in. at		\$	
	Meter	in. at		\$		
	Lead Joints	at		\$		
	Compound Joints	at		\$		
	Maintenance Foreman			\$		
	Hrs. Water Maint. Man-1	at		\$		
	Hrs. Water Maint. Man-2	at		\$		
	Hrs. Garage Foreman	at		\$		
	Hrs. Labor	at		\$		
	Hrs. Compressor	at		\$		
	Compensation Ins. at \$		per C	\$		
	Trucking			\$		
	Pav't Patch			\$		
	Tap by Giggard			\$		
	+ Co. 4-9-62			\$		
	O'head			\$		

45° Elbow on
comp. stop.

St. _____
Pl. _____
Ave. No. 6

Name of Owner
Maaroe
Lee J. Snow

Labor and Mat'l. Report April 9 1962

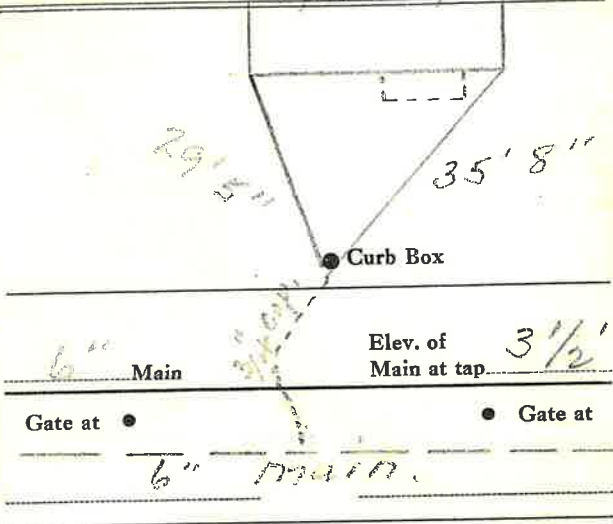

6" Main
Elev. of Main at tap 3 1/2'
Gate at • Gate at
6" main.

• Curb Box
Tap on side of main.

Tax ID # 302.16-11-19