

Labor and Materials

1	Copper	} Connection. ^{3/4"}	\$. 1.25
1	Lead			
1	Curb	} ^{3/4} in	\$. 1.70
	Cock Valve T.S.&V.			
1	Service Box	} Short 3 1/2 x 4 1/2	\$. 1.37
	Old returned			
		Brif. or Railway		
24	Ft. ^{3/4} in	} Copper Galv. Iron Cast Iron	Pipe at ^{1.3 1/2}	\$. 3.24
1	Nipples ^{3/4} in			
	Bushings to	in. at	\$
1	Red'g Ino'g	} Couplings. ¹ to ^{3/4} in	at	\$. 1.10
	Union in.	at	\$
	Meter in.	at	\$
	Lbs. Br. Stone	at		\$
	Lbs. Sand	at		\$
	Bags Cement	at		\$
	Paving Brick	} Mack Red Asphalt	at	\$
	Lead Joints			
	Leadite Joints	at		\$
5 1/2	Hrs. Foreman	at ^{6 2/2}		\$. 3.44
2 1/2	Hrs. Common Labor	at ⁵⁰		\$. 1.75
2 1/2	Hrs. Common Labor	at ⁴⁵		\$. 9.45
	Hrs. Mason	at		\$
	Hrs. Masons Helper	at		\$
	Hrs. Compressor	at		\$
	Compensation Ins		\$. 57
	Trucking		\$. 1.-
	Builders Use of Water		\$
Total				\$ 23.87

1935-119

Labor and Material Report

19

^{3/4}" tap at 14 Mant column

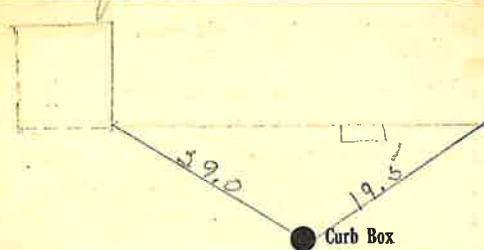

10" Main

Elev. of Main at tap 6

Gate at ●

● Gate at

● Curb Box

This ^{old} stop shut off at

Main

[Handwritten signature]

Tax 10# 309.27-6-30