

### Labor and Materials

1	Copper	Connection. 3/4"	\$ 1.25
1	Lead		
1	Curb	Cock Valve T.S.&V. 3/4 in	\$ 1.70
1	Service Box	Short 3 1/2 x 4 1/2	\$ 1.37
	Old returned	Long 4 1/2 x 5 1/2	
		Buff. or Rdway	
26	Ft. 3/4 in.	Copper Galv. Iron Cast Iron	Pipe at 13 1/2 \$ 3.51
	Nipples	in. at	\$
	Bushings	to in. at	\$
	Red'g Inc'g	Couplings to in. at	\$
	Union	in. at	\$
	Meter	in. at	\$
	Lbs. Br. Stone	at	\$
	Lbs. Sand	at	\$
	Bags Cement	at	\$
	Paving Brick	Mack Red Asphalt at	\$
	Lead Joints	at	\$
	Leadite Joints	at	\$
5 1/2	Hrs. Foreman	6 2/3	\$ 3.44
2 1/2	Hrs. Common Labor	50	\$ 1.75
4 1/2	Hrs. Common Labor	45	\$ 9.23
	Hrs. Mason	at	\$
	Hrs. Masons Helper	at	\$
	Hrs. Compressor	at	\$
	Compensation Ins		\$ 50
	Trucking		\$ 1-
	Builders Use of Water		\$
Total			\$ 73.19

1935-126

Labor and Material Report

Aug 10

1935

3/4" tap at 28 Montreal St

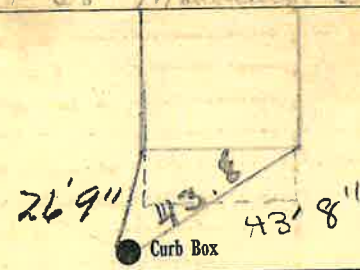

10" Main

Elev. of Main at tap 6

Gate at ●

● Gate at

● Curb Box

Old tap shut off at main

TAX ID # 309.27-6-37

*Handwritten signature*