

Labor and Materials

1	Copper	} Connection ^{3/4"}	\$ 1.75
1	Lead		
1	Curb	} Cock Valve T.S.&V. } ^{3/4} in	\$ 1.70
1	Service Box Old returned		} Short 3 1/4 x 4 1/4 } Long 4 1/2 x 5 1/2 } Buft. or Rdway }
10	Ft. ^{3/4} in.	} Copper Galv. Iron } Pipe at 13 1/2	
			} Cast Iron }
	Nipples in. at		\$
	Bushings to in. at	\$	
	Red'g Inc'g	} Couplings..... to in. at	\$	
	Union	 in. at	\$
	Meter in. at	\$	
	Lbs. Br. Stone	at	\$	
	Lbs. Sand	at	\$	
	Bags Cement	at	\$	
	Paving Brick	} Mack Red Asphalt }	at	\$
	Lead Joints		at	\$
	Leadite Joints	at	\$	
3	Hrs. Foreman	at ^{6 1/2 hr}	\$ 1.88	
8	Hrs. Common Labor	at ⁵⁰	\$ 4.00	
8	Hrs. Common Labor	at ⁴⁵	\$ 3.60	
	Hrs. Mason	at	\$	
	Hrs. Masons Helper	at	\$	
	Hrs. Compressor	at	\$	
	Compensation Ins	\$ 34	
	Trucking	\$ 1.00	
	Builders Use of Water	\$	
Total				\$ 16.57

1935-61

Labor and Material Report June 4 1935

3/4 tap at 59 Mantoloking st

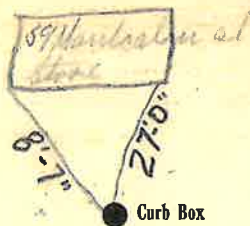

6" Main

Elev. of Main at tap 6.4

Gate at ●

● Gate at

● Curb Box

Old shut off at meter

Tax ID# 309.7-11-23