

Labor and Materials

1	Copper } Connection	3	\$	2.70
1	Lead } Connection	3	\$	2.39
1	Curb { Cock Valve F. S. & V. }	1	\$	2.39
	Service Box { Short 3/4 x 1/2 }		\$	1.45
	Old returned { Long 4/8 x 5/8 } Buff. or Rdway.		\$	1.45
27	Ft. in. { Copper Galv. Iron } Pipe at	3	\$	7.29
	Nipples in. at.		\$	
	Bushings to in. at.		\$	
	Red'g } Couplings to in. at		\$	
	Inc'g }		\$	
	Union in. at.		\$	
	Meter in. at		\$	
	Lbs. Br. Stone at.		\$	
	Lbs. Sand at		\$	
	Bags Cement at.		\$	
	Paving Brick { Mack Red Asphalt } at		\$	
	Lead Joints at.		\$	
	Leadite Joints at.		\$	
3	Hrs. Foreman at		\$	1.88
8	Hrs. Common Labor at		\$	3.60
	Hrs. Common Labor at		\$	
	Hrs. Mason at		\$	
	Hrs. Mason's Helper at		\$	
	Hrs. Compressor at		\$	
	Compensation Ins.		\$.17
	Trucking		\$	1.-
	Builders' Use of Water <i>patch</i>		\$	5.-
Total \$				25.48

30-45
Labor and Material Report

19

64 *Manhattan St.*

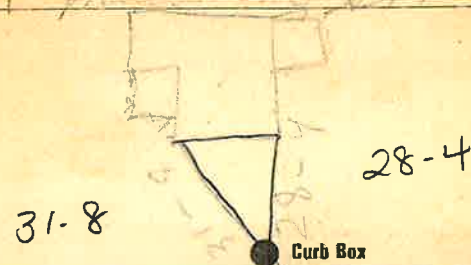

6 Main

Elev of Main at tap 5

Gate at ●

● Gate at

● Curb Box

Old tap to be dug up.