

### Labor and Materials

1	Copper	} Connection $\frac{3}{4}$ "	.....	\$ 1.25
1	Lead			
1	Curb	} Cock Valve T.S.&V. } $\frac{3}{4}$ in	.....	\$ 1.70
1	Service Box		} Short $3\frac{1}{2} \times 4\frac{1}{2}$ Long $4\frac{1}{2} \times 5\frac{1}{2}$ Buff. or Rawer	.....
8	Ft. .... in.	} Copper Galv. Iron } Pipe at 13.14		.....
	Nipples		} Cast Iron	.....
1	Bushings	.....		\$
	Red'g Inc'g	} Couplings	.....	\$
	Union		.....	\$
	Meter	.....	\$	
	Lbs. Br. Stone	.....	\$	
	Lbs. Sand	.....	\$	
	Bags Cement	.....	\$	
	Paving Brick	} Mack Red Asphalt	.....	\$
	Lead Joints		.....	\$
	Leadite Joints	.....	\$	
2	Hrs. Foreman	.....	\$	1.25
1	Hrs. Common Labor	.....	\$	.50
6.12	Hrs. Common Labor	.....	\$	2.93
	Hrs. Mason	.....	\$	
	Hrs. Masons Helper	.....	\$	
	Hrs. Compressor	.....	\$	
	Compensation Ins	.....	\$	.18
	Trucking	.....	\$	1.-
	Builders Use of Water	.....	\$	
Total				\$ 11.31

1935-12

Labor and Material Report Aug 24 1935

$\frac{3}{4}$ " tap at 81 Chestnut St

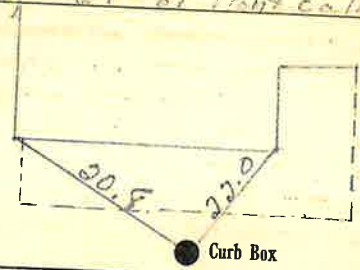

6" Main

Elev. of Main at tap 5'

Gate at ●

● Gate at

● Curb Box

*old shut off at main*

*[Handwritten signature]*