

LABOR AND MATERIALS

1	Copper	} Connection <sup>3/4"</sup>	\$
1	Lead		
1	Curb	} Cock Valve T.S. & V. } <sup>3/4 in. Oriseal.</sup>	\$
1	Service box		
1	Old returned	} Short 3 1/2 x 4 1/2 } Long 4 1/2 x 5 1/2 } Buff or Rdway }	\$
12	Ft. <sup>3/4</sup> in.		
		} Copper } C.I. } C.I. }	Pipe at \$
	Nipples		
	Bushings	to in. at \$	
	Red'g } Inc'g }	} Coupl'gs to in. at \$	
	Union		in. at \$
	Meter	in. at \$	
	Lead Joints	at \$	
	Compound Joints	at \$	
	Maintenance Foreman	\$	
	Hrs. Water Maint. Man-1	at \$	
	Hrs. Water Maint. Man-2	at \$	
	Hrs. Garage Foreman	at \$	
	Hrs. Labor	at \$	
	Hrs. Compressor	at \$	
	Compensation Ins. at \$	per C. \$	
	Trucking	\$	
	Pav't Patch	\$	
	Tap by Kelly & Co.	\$	
	4-16-64.	\$	
	O'head	\$	
		\$	

~~St.~~  
~~Pl.~~  
Ave. No. 57

Name of Owner  
Casper George

Labor and Mat'l. Report Apr. 16 1964

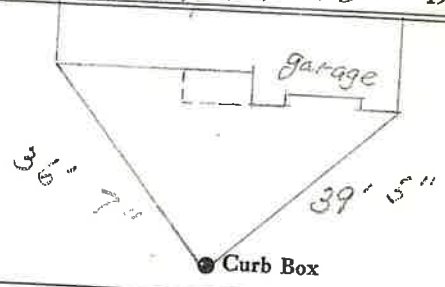

6" Main      Elev. of Main at tap 5'  
Gate at ●      ● Gate at

● Curb Box

Tax ID # 302.11-7-29