

LABOR AND MATERIALS

1	Copper Lead	Connection	$\frac{3}{4}$		\$ 1.23	
1	Curb	Cock Valve T-S. & V.	$\frac{3}{4}$	in.	\$ 1.68	
1	Service Box Old-returned	Short $3\frac{1}{2} \times 4\frac{1}{2}$ Long $4\frac{1}{2} \times 5\frac{1}{2}$ Buff. or Rdway			\$ 1.54	
30	Ft.	$\frac{3}{4}$ in.		Copper Galv Iron Cast Iron Pipe at 17	\$ 5.10	
	Nipples	in.	at		\$	
	Bushings	to	in.	at	\$	
	Red'g Inc'g	Couplings	to	in.	at	\$
	Union	in.	at		\$	
	Meter	in.	at		\$	
	Lead Joints	at			\$	
	Leadite Joints	at			\$	
	Hrs. Foreman	at			\$	
4	Hrs. Chauffeur	at	62 $\frac{1}{2}$		\$ 2.50	
8	Hrs. Tapper	at			\$ 5.00	
8	Hrs. Labor	at	45		\$ 3.60	
	Hrs. Labor	at			\$	
4	Hrs. Compressor	at	65		\$ 2.60	
	Compensation Ins.				\$ 34	
	Trucking				\$ 1	
	Builders Use of Water				\$	
	Tap by Messel				\$	
	Patch $\frac{1}{2}$ Sewer				\$ 2.50	
					\$	
					\$ 27.09	

5 - - 1939

St.

Pl.

Monument Ave. No. 14

Name of Owner

Sofran

Labor and Mat'l. Report

Mar 849 1939

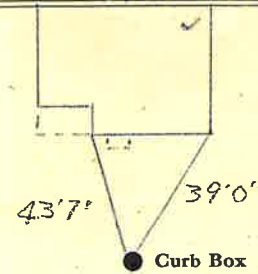

6 Main

Elev. of Main at tap 4 $\frac{1}{2}$

Gate at ●

● Gate at

● Curb Box

Tax ID# 302.11-8-12

New Tap 44