

LABOR AND MATERIALS

1 Copper } Connection  $3/4"$  \$ \_\_\_\_\_  
 Lead }  
 1 Curb } Cock  $1 1/2$  }  
 Valve }  $1 3/4$  in. \$ \_\_\_\_\_  
 T.S. & V. }  
 1 Service box { Short  $3 1/2 \times 4 1/2$  }  
 Old returned { Long  $4 1/2 \times 5 1/2$  } \$ \_\_\_\_\_  
 { Buff or Rdway }  
 26 Ft.  $3/4$  in. { Copper } Pipe at \$ \_\_\_\_\_  
 { C.I. }  
 { C.I. }  
 Nipples in. at \$ \_\_\_\_\_  
 Bushings to in. at \$ \_\_\_\_\_  
 Red'g }  
 Inc'g } Coupl'gs. to in. at \$ \_\_\_\_\_  
 Union in. at \$ \_\_\_\_\_  
 Meter in. at \$ \_\_\_\_\_  
 Lead Joints at \$ \_\_\_\_\_  
 Compound Joints at \$ \_\_\_\_\_  
 Maintenance Foreman \$ \_\_\_\_\_  
 Hrs. Water Maint. Man-1 at \$ \_\_\_\_\_  
 Hrs. Water Maint. Man-2 at \$ \_\_\_\_\_  
 Hrs. Garage Foreman at \$ \_\_\_\_\_  
 Hrs. Labor at \$ \_\_\_\_\_  
 Hrs. Compressor at \$ \_\_\_\_\_  
 Compensation Ins. at \$ per C \$ \_\_\_\_\_  
 Trucking \$ \_\_\_\_\_  
 Pay't Patch \$ \_\_\_\_\_  
 Tap made 4-14-65 \$ \_\_\_\_\_  
 By Gifford & Co. \$ \_\_\_\_\_  
 O'head \$ \_\_\_\_\_

St. \_\_\_\_\_  
 Ave. No. 9

Morton  
 Name of Owner  
Mathewine Hart

Labor and Mat'l. Report April 14 1965

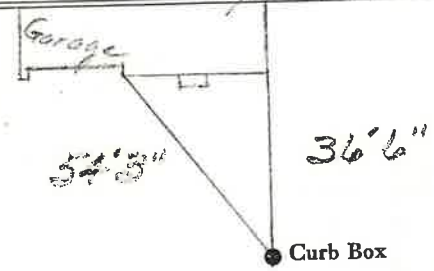

6" C.I. Main Elev. of Main at tap 5 1/2'  
 Gate at • Gate at •

• Curb Box  
 Tax ID# 309.7-7-3