

LABOR AND MATERIALS

|   |                       |                               |           |            |          |
|---|-----------------------|-------------------------------|-----------|------------|----------|
| 1 | Copper Lead           | { Connection                  | 3/4       |            | \$ 1.31  |
| 1 | Curb                  | { Cock Valve                  | 3/4       | in.        | \$ 1.75  |
| 1 | Service Box           | { Short 3 1/2 x 4 1/2         |           |            | \$ 1.60  |
|   | Old returned          | { Long 4 1/2 x 5 1/2          |           |            |          |
|   |                       | { Buff. or Rdway              |           |            |          |
| 7 | Ft. 3/4 in.           | { Copper Galv. Iron Cast Iron |           | Pipe at 18 | \$ 1.26  |
|   | Nipples               | in. at                        |           |            | \$       |
|   | Bushings              | to in. at                     |           |            | \$       |
|   | Red'g Inc'g           | { Couplings                   | to in. at |            | \$       |
|   | Union                 | in. at                        |           |            | \$       |
|   | Meter                 | in. at                        |           |            | \$       |
|   | Lead Joints           | at                            |           |            | \$       |
|   | Leadite Joints        | at                            |           |            | \$       |
|   | Hrs. Foreman          | at                            |           |            | \$       |
| 2 | Hrs. Chauffeur        | at                            | 6 1/2     |            | \$ 1.25  |
| 5 | Hrs. Tapper           | at                            | 7         |            | \$ 3.12  |
| 5 | Hrs. Labor            | at                            | 45        |            | \$ 2.75  |
|   | Hrs. Labor            | at                            |           |            | \$       |
|   | Hrs. Compressor       | at                            |           |            | \$       |
|   | Compensation Ins.     |                               |           |            | \$ 21    |
|   | Trucking              |                               |           |            | \$ 1-    |
|   | Builders Use of Water | Patch                         |           |            | \$ 5.00  |
|   | Taps by Messer        |                               |           |            | \$       |
|   |                       |                               |           |            | \$       |
|   |                       |                               |           |            | \$       |
|   |                       |                               |           |            | \$       |
|   |                       |                               |           |            | \$       |
|   |                       |                               |           |            | \$ 18.75 |

37 - - 1940

St. 23

Pr. 17

Murdock Ave. No. 17

Name of Owner

Callahan

Labor and Mat'l. Report May 25 1940

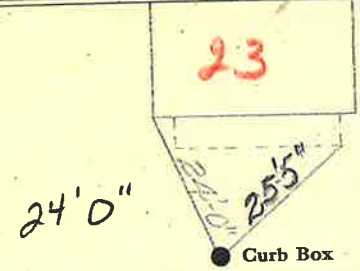

4 Main

Elev. of Main at tap 9'

Gate at ●

● Gate at

● Curb Box

TAX ID# 302.12-22-4

5/30