

Labor and Materials

1	Lead Connection		\$ 3.20
1	Curb Cock		\$ 1.00
1	Service Box (Short 2 1/2 x 4 1/2) Old returned (Long 4 1/2 x 5 1/2) Burial		\$ 1.40
6	3/4" in. G. I. Pipe at hopper		\$ 1.32
	Nipples.....in. at.....		\$
	Bushings.....to.....in. at.....		\$
	Red'g Coup.....to.....in. at.....		\$
	Inc'g Coup.....to.....in. at.....		\$
	Union.....in. at.....		\$
	Meter.....in. at.....		\$
	Cu. Yds. Br. Stone at.....		\$
	Cu. Yds. Sand at.....		\$
	Bags Cement at.....		\$
	Paving Brick { Mack Red Asphalt } at.....		\$
7	Hrs. Foreman at 62.15-		\$ 4.37
8	Hrs. Common Labor at 50		\$ 4.00
	Hrs. Mason at.....		\$
	Hrs.....at.....		\$
	Hrs.....at.....		\$
	Builders' Use of Water.....		\$
	Gas.....at.....		\$ 23
	Terrace.....at.....		\$ 100
at.....		\$
at.....		\$
	Total		\$ 16.52

Labor and Material Report

May 1 1926

3/4" top at 21 Woodcock Ave

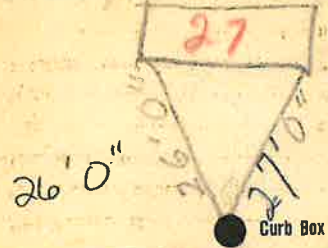

4" Main Elev. of Main at tap 4 1/2
Gate at ● Gate at ●

● Curb Box.

6' 3/4" To main
TAX ID # 302.12-22-2