

Labor and Materials

Copper	} Connection.....	3 4	\$ 2.60	
Lead					
Curb	} Cock Valve T.S.&V. }	in 3 4	\$ 2.27
Service Box Old returned					
28 Ft. 3 4 in.	} Copper Galv. Iron Cast Iron }	Pipe at	\$ 5.04	
Nipples				
Bushings	to	in. at	\$	
Red'g Inc'g	} Couplings.....	to	in. at	\$	
Union				
Meter	in. at	\$		
Lbs. Br. Stone	at	\$			
Lbs. Sand	at	\$			
Bags Cement	at	\$			
Paving Brick	} Mack Red Asphalt }	at	\$		
Lead Joints		at	\$		
Leadite Joints	at	\$			
3 Hrs. Foreman	at	\$ 1.88			
12 Hrs. Common Labor	at	\$ 4.50			
Hrs. Common Labor	at	\$			
Hrs. Mason	at	\$			
Hrs. Masons Helper	at	\$			
Hrs. Compressor	at	\$			
Compensation Ins	\$ 20			
Trucking	\$ 1-			
Builders Use of Water	Patch	\$ 5-			
Total				\$ 23.87	

532-24 12 22 1922
Labor and Material Report

8 Wendock Ave

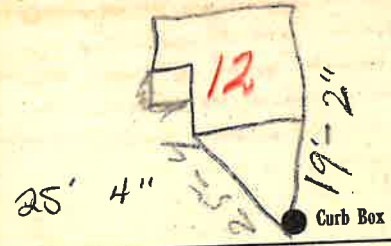

4 Main Elev. of Main at tap 4 1/2
Gate at ● Gate at ●

● Curb Box

old House
" Tap shut off.

TAX ID# 302.12-21-5

OK [Signature]