

LABOR AND MATERIALS

1	Copper	Connection	1"	\$	4.28
1	Lead				
1	Curb	Cock Valve	1 in.	\$	5.25
		T.S. & V.			
1	Service box	Short 3 1/2 x 4 1/2		\$	4.69
	Old returned	Long 4 1/2 x 5 1/2			
		Buff. or Rdway			
19	Ft. 1 in.	Copper	Pipe at	56	\$10.64
		G.I.			
		G.I.			
	Nipples	in. at		\$	
	Bushings	to in. at		\$	
	Red'g				
	Inc'g	Coupl'gs to in. at		\$	
	Union	in. at		\$	
	Meter	in. at		\$	
	Lead Joints	at		\$	
	Compound Joints	at		\$	
	Maintenance Foreman			\$	
	Hrs. Water Maint. Man-1	at		\$	
8	Hrs. Water Maint. Man-2	at 1.24		\$	9.92
	Hrs. Garage Foreman	at		\$	
16	Hrs. Labor	at 1.13		\$	18.08
	Hrs. Compressor	at		\$	
	Compensation Ins. at \$4.29	per C		\$	1.70
	Trucking			\$	1.50
	Pay't Patch			\$	9.00
	Tap by Gifford 7-655			\$	
				\$	
				\$	
	O'head			\$	
				\$	64.56

East

Notre Dame

St.

Pt.

Ave. No. 6

Name of Owner

Phil. Rose

Labor and Mat'l. Report

July 6 1955

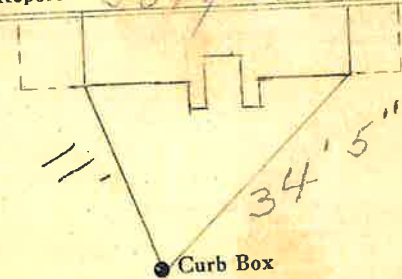

6" Main

Elev. of

Main at tap

5'

Gate at ●

● Gate at

● Curb Box

Tax 10# 302.20-12-15