

Labor and Materials

1	Copper } Connection	3/4	\$ 3.20
1	Lead } Cock Valve		
1	Curb } T.S. & V.	3/4 in.	\$ 1.00
1	Service Box } Short 3 1/2 x 4 1/2		
	Old returned } Long 4 1/2 x 5 1/2		\$ 1.30
		Buff. or Rdway	
23	Ft. 3/4 in. } Copper Galv. Iron Pipe at	3/4	\$ 50.6
		Cast Iron	
	Nipples.....	in. at	\$
	Bushings.....	to..... in. at	\$
1	Redg. } Couplings.....	to..... in. at	\$ 15
	Union.....	in. at	\$
	Meter.....	in. at	\$
	Lbs. Br. Stone at	\$
	Lbs. Sand at	\$
	Bags Cement at	\$
	Paving Brick } Mack Red Asphalt	at	\$
	Lead Joints at	\$
	Leadite Joints at	\$
7	Hrs. Foreman at	6.25	\$ 4.37
24	Hrs. Common Labor at	50	\$ 12.00
	Hrs. Common Labor at	\$
	Hrs. Mason at	\$
	Hrs. Mason's Helper at	\$
1	Hrs. Compressor at	2.00	\$ 2.00
	Compensation Ins.	\$ 4.9
1	Trucking	\$ 1.00
	Builders' Use of Water	\$
Total				\$ 30.57

Labor and Material Report

1926

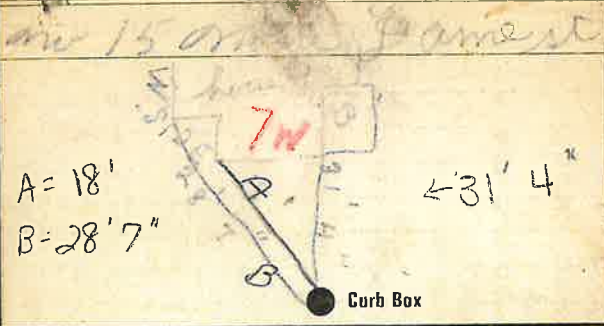

6" Main Elev. of Main at tap 5'

Gate at ● ● Gate at

● Curb Box

TAX 10th 302.20-7-26