

LABOR AND MATERIALS

1	Copper	Connection	3/4"	\$ 2.71
1	Lead			
1	Curb	Cock Valve	3/4 in.	\$ 3.83
		T.S. & V.		
1	Service box	Short 3 1/2 x 4 1/2		
		Long 4 1/2 x 5 1/2		
1	Old returned	Buff or Rdway		\$ 4.69
10	Ft.	Curb	3/4 in. Pipe at	\$ 4.50
		C.I.		
		C.I.		
	Nipples	in. at		\$
	Bushings	to in. at		\$
	Red'g			\$
	Inc'g	Coupl'gs to in. at		\$
	Union	in. at		\$
	Meter	in. at		\$
	Lead Joints	at		\$
	Compound Joints	at		\$
	Maintenance Foreman			\$
	Hrs. Water Maint. Man-1	at		\$
6	Hrs. Water Maint. Man-2	at	1.24	\$ 7.44
1	Hrs. Garage Foreman	at		\$ 1.59
14	Hrs. Labor	at	1.13	\$ 15.82
	Hrs. Compressor	at		\$
	Compensation Ins. at	\$ 4.29 per C		\$ 1.07
	Trucking			\$ 1.50
	Pav't Patch			\$ 11.20
	Tap by Gifford			\$
		5-11-55		\$
	O'head			\$
				\$54.35

St.
~~Pt.~~
W. Notre Dame Ave. No. 45

Name of Owner
Dr. Henry Clark

Labor and Mat'l. Report May 11 1955

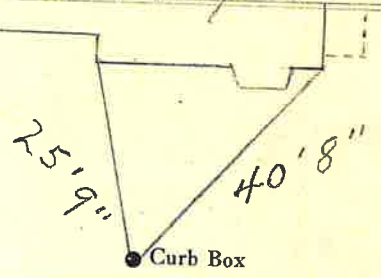

Crandall St.

10" Main Elev. of Main at tap 6'

Gate at • Gate at

TAX ID# 302.20-3-19

● Curb Box

Tap on Crandall St.