

Labor and Materials

1	Copper	Connection	320
1	Lead		
1	Curb	{ Cock Valve } 3/4 in	1.75
		{ T.S. & V. }	
1	Service Box	{ Short 3/4 x 4 1/2 }	1.40
	Old returned	{ Long 4 1/2 x 5 1/2 }	
		{ Butts or Rdway }	
9	Ft. 3/4 in.	{ Copper Galv. Iron } Pipe at	1.95
		{ Cast Iron }	
1	Nipples	3/4 in. at	
1	Bushings	1/2 to 3/4 in. at	1.12
1	Red'x Inc'x	Couplings 1/2 to	1.15
		in. at	
	Union	in. at	
	Meter	in. at	
	Lbs. Br. Stone	at	
	Lbs. Sand	at	
	Bags Cement	at	
	Paving Brick	{ Mack Red Asphalt } at	
	Lead Joints	at	
	Leadite Joints	at	
	Hrs. Foreman	at	
13	Hrs. Common Labor	at	5.28
	Hrs. Common Labor	at	
	Hrs. Mason	at	
	Hrs. Mason's Helper	at	
	Hrs. Compressor	at	
	Compensation Ins.		14
1	Trucking		1.50
	Builders' Use of Water		
Total			14.27

Labor and Material Report

42

June 15 1937

42 Capland
Citizens' Savings Bank

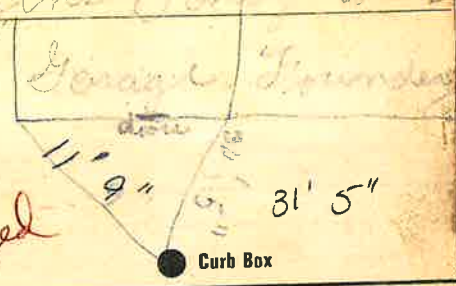

6" Main
Elev. of Main at tap 5'
Gate at ● Gate at ●

● Curb Box

