

Labor and Materials

1	Copper	Connection	3/4	\$	320
	Lead				
1	Curb	Cock Valve T.S. & V.	7/8 in.	\$	1.50
1	Service Box	Short 3 1/2 x 4 1/2		\$	140
	Old returned	Long 4 1/2 x 5 1/2		\$	
		Buff. or Rdway		\$	
10	Ft. 2 1/2 in.	Copper Galv. Iron Cast Iron	Pipe at	\$	254
	Nipples	in. at		\$	
	Bushings	to in. at		\$	
1	Red'g Inc'g	Couplings	3/4 to in. at	\$	1.15
	Union	in. at		\$	
	Meter	in. at		\$	
	Lbs Br. Stone	at		\$	
	Lbs. Sand	at		\$	
	Bags Cement	at		\$	
	Paving Brick	Mack Red Asphalt	at	\$	
	Lead Joints	at		\$	
	Leadite Joints	at		\$	
	Hrs. Foreman	at		\$	
13	Hrs. Common Labor	at		\$	5.28
	Hrs. Common Labor	at		\$	
	Hrs. Mason	at		\$	
	Hrs. Mason's Helper	at		\$	
	Hrs. Compressor	at		\$	
	Compensation Ins.			\$	14
1	Trucking			\$	1.50
	Builders' Use of Water			\$	
Total				\$	14.81

Labor and Material Report

50

June 15 19 21

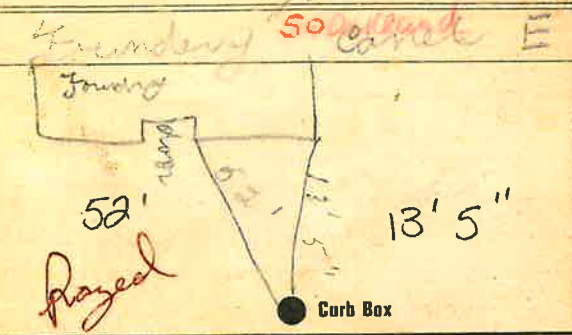

6" Main Elev. of Main at tap 5'

Gate at ● ● Gate at

● Curb Box

~~E. 1.50~~