

LABOR AND MATERIALS

1	Copper } Connection $\frac{3}{4}$		\$ 1.35
	Lead } Connection $\frac{3}{4}$		
1	Curb } Cock Valve } $\frac{3}{4}$ in.		\$ 1.80
	} T.S. & V. }		
1	Service Box } Short $\frac{3}{4}$ x4 $\frac{1}{2}$		
	Old returned } Long 4 $\frac{1}{2}$ x5 $\frac{1}{2}$		\$ 1.70
	} Buffer Rdway }		
23 Ft. $\frac{3}{4}$	Curb } Copper } Pipe at 18		\$ 4.14
4	} Galv Iron }		
	} Cast Iron }		
	Nipples..... in. at	\$	
	Bushings..... to..... in. at	\$	
	Red'g } Couplings..... to..... in. at	\$	
	Inc'g }		
	Union..... in. at	\$	
	Meter..... in. at	\$	
	Lead Joints at	\$	
	Leadite Joints at	\$	
	Hrs. Foreman at	\$	
1 1/2	Hrs. Chauffeur at 6 3/4	\$.94
3	Hrs. Tapper at	\$	1.88
19	Hrs. Labor at 45	\$	8.55
	Hrs. Labor at	\$	
	Hrs. Compressor at	\$	
	Compensation Ins.	\$.35
	Trucking	\$	1.-
	Builders Use of Water Before Draining	\$	
	Tap by Hessel	\$	
		\$	
		\$	
		\$	
		\$	
		\$	21.71

6 2 1941

St. 26
 Pt.
 Ave. No. 24

Name of Owner

Miles Hark

Labor and Mat'l. Report

May 20 19 *41*

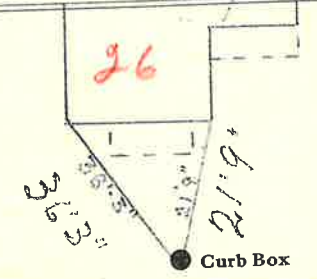

4 Main Elev. of Main at tap 5

Gate at ● Gate at ●

Tax ID # 302.16-4-12

● Curb Box