

LABOR AND MATERIALS

1	Copper Lead	} Connection	$\frac{3}{4}$		\$ 1.35
1	Curb	{ Cock Valve T.S. & V.	$\frac{3}{4}$ in.		\$ 1.80
1	Service Box Old returned	{ Short $3\frac{1}{2} \times 4\frac{1}{2}$ Long $4\frac{1}{2} \times 5\frac{1}{2}$ Buff or Rdway			\$ 1.70
32	Ft.	{ Copper Galv Iron Cast Iron	$\frac{3}{4}$ in.	Pipe at 18	\$ 5.76
	Nipples			in. at	\$
	Bushings			to in. at	\$
	Red'g Inc'g	{ Couplings		to in. at	\$
	Union			in. at	\$
	Meter			in. at	\$
	Lead Joints			at	\$
	Leadite Joints			at	\$
	Hrs. Foreman			at	\$
3	Hrs. Chauffeur		62 1/2	at	\$ 1.88
5	Hrs. Tapper		7	at	\$ 3.12
20	Hrs. Labor		45	at	\$ 9.-
	Hrs. Labor			at	\$
	Hrs. Compressor			at	\$
	Compensation Ins.				\$ 43
	Trucking				\$ 1.-
	Builders Use of Water	Before Paving			\$
	Tap by Hessel				\$
	Tap on Thomson				\$
					\$ 26.04

73 1941

St. 28
 Pl. 26
 Ave. No. 26

Name of Owner

Hansen

Labor and Mat'l. Report

June 26 1941

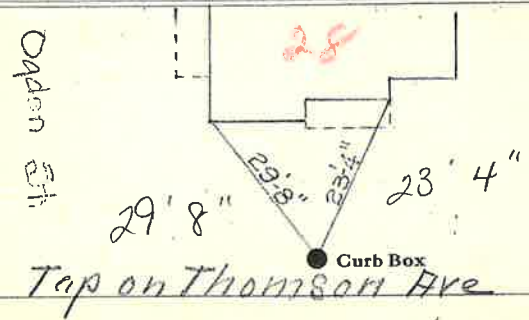

6 Main Thomson Ave. Elev. of Main at tap 5-

Gate at ● Gate at ●

● Curb Box

Tap ID # 302.16-4-13

To be Billed