

LABOR AND MATERIALS

1	Copper Lead	} Connection ^{1/2" x 3/4"} Corp. stop	\$
1	Curb		\$ 389
		} Cock Valve T.S. & V. } 3/4 in.	
1	Service box		{ Short 3 1/2 x 4 1/2 Long 4 1/2 x 5 1/2 Buff or Rdway
15	Ft. 3/4 in.	{ Copper G.I. G.I. } Pipe at 45	\$ 6.75
	Nipples	in. at	\$
	Bushings	to in. at	\$
	Red'g Inc'g	Coupl'gs to in. at	\$
	Union	in. at	\$
	Meter	in. at	\$
	Lead Joints	at	\$
	Compound Joints	at	\$
	Maintenance Foreman		\$
	Hrs. Water Maint. Man	1 at	\$
	Hrs. Water Maint. Man	2 at	\$
3	Hrs. Garage Foreman	at	\$ 6.10
3	Hrs. Labor	at 1.30	\$ 3.90
	Hrs. Compressor	at	\$
	Compensation Ins.	at \$ 56.96 per C	\$
	Trucking		\$ 1.50
	Pay't Patch		\$
	Tap by Hancock & Wadleigh	11-8-56	\$
	O'head		\$

✓ Lot-10
St. 8
Pl.
Ave. No. 10
Old Forge Rd.

Name of Owner
Hay

Labor and Mat'l. Report Nov. 8 1956

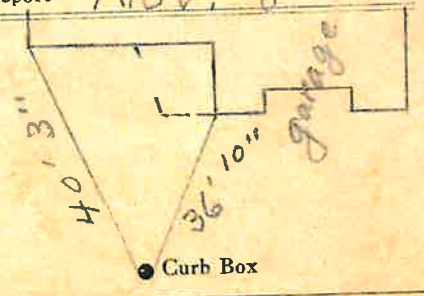

Galv. 2" Main
Elev. of Main at tap 5'

Gate at • Gate at •
TAX ID # 302.13-1-34

• Curb Box