

LABOR AND MATERIALS

1	Copper Lead	Connection	3/4" Male Adapter	\$ 73
1	Curb	Cock Valve T.S. & V.	3/4 in.	\$ 3.83
1	Service box	Short 3 1/2 x 4 1/2		
	Old returned	Long 4 1/2 x 5 1/2		
		Buff or Rdway		\$ 4.69
16	Ft.	3/4 in. Copper G.I. C.I.	Pipe at 45	\$ 7.70
	Nipples	in. at		\$
1	Bushings	2" to 3/4 in.	at	\$ 27
	Red'g Inc'g	Coupl'gs	to in. at	\$
	Union	in. at		\$
	Meter	in. at		\$
	Lead Joints	at		\$
	Compound Joints	at		\$
	Maintenance Foreman			\$
	Hrs. Water Maint. Man	1 at		\$
	Hrs. Water Maint. Man	2 at		\$
2	Hrs. Garage Foreman	at 1.59		\$ 3.18
2	Hrs. Labor	at 1.13		\$ 2.26
	Hrs. Compressor	at		\$
	Compensation Ins.	at \$ 4.29 per C		\$ 23
	Trucking			\$ 1.50
	Pav't Patch			\$
	Tap by Wadleigh & Harbeau	10-10-55		\$
	O'head			\$
				\$ 73.89

Lot-15

Old Forge Road St. Pl. Ave. No. 18

Name of Owner PENNOCK Humphrey

Labor and Mat'l. Report Nov. 10 1955

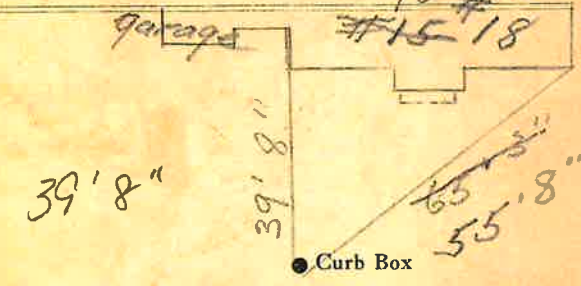

2" galv. Main Elev. of Main at tap 4'

Gate at • Gate at

TAX 10 # 302.17-4-4

• Curb Box