

LABOR AND MATERIALS

?	Copper	} Connection	_____	\$	
	Lead				
	Curb	} Cock Valve T. S. & V.	_____ in.	\$	
	Service box	} Short 3 1/2 x 4 1/2 Long 4 1/2 x 5 1/2 Buff or Rdway	_____	\$	
	Old returned				
?	Ft. ?	} Copper G. I. ?	_____ Pipe at	\$	
	in.				
	Nipples	_____ in. at		\$	
	Bushings	_____ to _____ in. at		\$	
	Red'g	} Coupl'gs	_____ to _____ in. at	\$	
	Inc'g				
	Union	_____ in. at		\$	
	Meter	_____ in. at		\$	
	Lead Joints at			\$	
	Compound Joints at			\$	
	Maintenance Foreman			\$	
	Hrs. Water Maint. Man-1 at			\$	
	Hrs. Water Maint. Man-2 at			\$	
	Hrs. Garage Foreman at			\$	
	Hrs. Labor— at			\$	
	Hrs. Compressor at			\$	
	Compensation Ins. at \$ _____ per C.			\$	
	Trucking			\$	
	Pav't Patch			\$	
				\$	
				\$	
	O'head			\$	
				\$	

IN 1100 ft. Red
30 Park St. Pl. #30
Ave. No.

Name of Owner
Hoag's Tire Shop

Labor and Mat'l. Report April 15 1964.

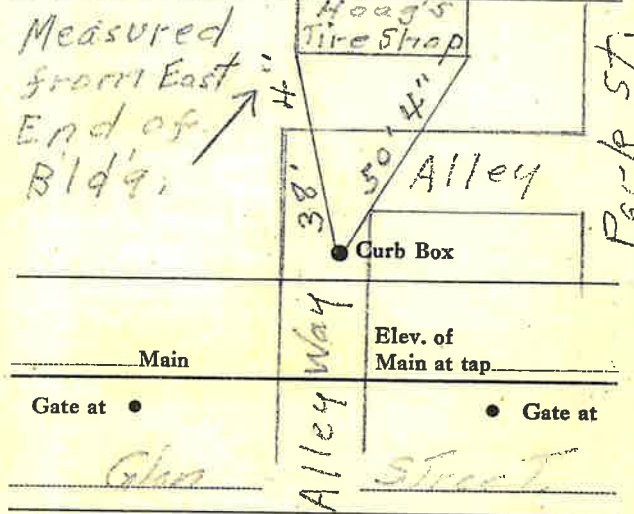

Gate at • Elev. of Main at tap
Gate at •

Alley Street

• Curb Box

This Tap on Sawyer's 6" Line.

||||| →