

Labor and Materials

Lead Connection	\$
Curb Cock	\$
Service Box { Short 3½ x 4½ Old returned { Long 4½ x 5½ Buffalo	\$
Ft. in. G. I. Pipe at	\$
Nipples, in. at	\$
Bushings in. at	\$
Red'g Coup. to in. at	\$
Inc'g Coup. to in. at	\$
Union in. at	\$
Meter in. at	\$
Cu. Yds. Br. Stone at	\$
Cu. Yds. Sand at	\$
Bags Cement at	\$
Pav. Brick { Mack Red Asphalt } at	\$
Hrs. Foreman at	\$
Hrs. Com. Labor at	\$
Hrs. Mason at	\$
Hrs. at	\$
Hrs. at	\$
Builders' Use of Water	\$
at	\$
at	\$
at	\$
at	\$
Total \$	\$

Order and Material Report

19

2" + 4" Taps to Downy Gutter

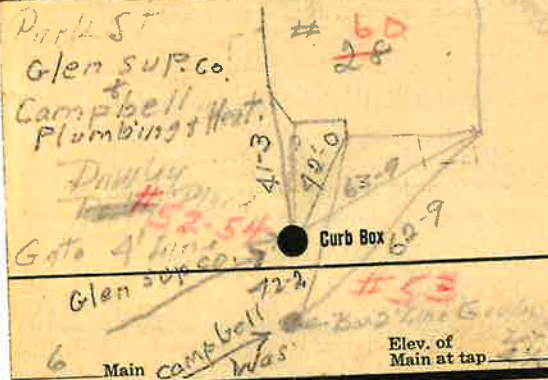

Gate at ● Spectors ● Gate at

- | | | |
|---------------------|------------|----------------|
| 12' off 4" Pipe | ● Curb Box | 16' of 2" Pipe |
| 1-6x4 Sleeve Taping | | 1-2x6 Taping |
| 1-4' Taping Gate | | 1-2" " Gate |
| 1-4' Plug | | 2-6' joints |
| 2-4' joints | | 1-2" Plug |
| 2-6' " | | 1- Gate Box |
| 1 Gate Box | | |

Labor and Materials

.....Lead Connection\$.....
.....Curb Cock.....\$.....
.....Service Box { Short 3 1/2 x 4 1/2 Old returned { Long 4 1/2 x 5 1/2 Buffalo\$.....
.....12 Ft.in. G. I. Pipe at.....\$.....
.....Nipples.....in. at.....\$.....
.....1 Bushingsto 3/4 in. at.....\$.....
.....Red'g Coup....to....in. at.....\$.....
.....Inc'g Coup....to....in. at.....\$.....
.....Union....in. at.....\$.....
.....Meter....in. at.....\$.....
.....Cu. Yds. Br. Stone at.....\$.....
.....Cu. Yds. Sand at.....\$.....
.....Bags Cement at.....\$.....
.....Paving Brick { Mack Red Asphalt } at.....\$.....
.....3 Hrs. Foreman at.....\$.....
.....10 Hrs. Common Labor at.....\$.....
.....Hrs. Mason at.....\$.....
.....Hrs.....at.....\$.....
.....Hrs.....at.....\$.....
.....900 Builders' Use of Water\$.....
.....at.....\$.....
.....Truck 150.....at.....\$.....
.....at.....\$.....
.....at.....\$.....
.....at.....\$.....
.....Total.....\$ 13.80.....

Labor and Material Report

Oct 22 1923

3/4 *27 Park Road*

House

Rogel

28' 3" *27' 0"*

● Curb Box

Main Elev. of Main at tap *1113*

Gate at ● ● Gate at

● Curb Box