

LABOR AND MATERIALS

1	Copper	} Connection	3/4"	\$	2.41
	Lead				
1	Curb	} Cock Valve T.S. & V.	} 3/4 in.	\$	3.41
1	Service box				
	Old returned				
			{ Short 3 1/2 x 4 1/2 Long 4 1/2 x 5 1/2 Buff or Rdway }	\$	4.18
9	Ft. 3/4 in.	} Copper <del>C.I.</del> <del>C.I.</del>	} Pipe at	\$	3.60
	Nipples	in. at		\$	
	Bushings	to in. at		\$	
	Red'g } Inc'g }	Coupl'gs	to in. at	\$	
	Union	in. at		\$	
	Meter	in. at		\$	
	Lead Joints	at		\$	
	Compound Joints	at		\$	
	Maintenance Foreman			\$	
	Hrs. Water Maint. Man-1	at		\$	
6	Hrs. Water Maint. Man-2	at 1.24		\$	7.44
	Hrs. Garage Foreman	at		\$	
10	Hrs. Labor	at 1.13		\$	11.30
	Hrs. Compressor	at		\$	
	Compensation Ins.	at 7.861 per C.		\$	7.2
	Trucking			\$	1.50
	Pay't Patch			\$	13.44
	Tap by Giggard	10-26-54		\$	
	O'head			\$	
				\$	48.00

34.56

92-54

St. Pt. Ave. No. 15

Parker  
Name of Owner  
Eastwood

Labor and Mat'l. Report Oct, 26 1954

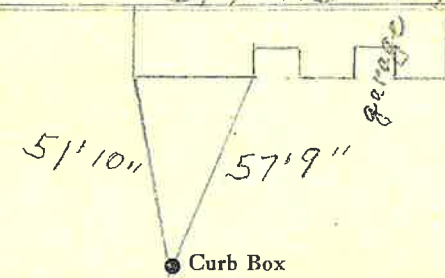

Arbor Drive  
6" Main Elev. of Main at tap 5'  
Gate at • Gate at

• Curb Box  
Tap on Arbor Drive