

LABOR AND MATERIALS

1 Copper } Connection 1 1/4" \$  
~~Lead~~ }  
 1 Curb } Cock } 1 1/4 in. oriseal. \$  
 } Valve }  
 } T.S. & V. }  
 1 Service box } Short 3 1/2 x 4 1/2 } oriseal \$  
~~Old returned~~ } Long 4 1/2 x 5 1/2 } Curb box. \$  
 } Buff or Rdway }  
 25' 8" } 1 1/4 in. } { Copper } Pipe at \$  
 } { G.I. }  
 } { G.I. }  
 Nipples in. at \$  
 Bushings to in. at \$  
 Red'g }  
 Inc'g } Coupl'gs to in. at \$  
 Union in. at \$  
 Meter in. at \$  
 Lead Joints at \$  
 Compound Joints at \$  
 Maintenance Foreman \$  
 Hrs. Water Maint. Man-1 at \$  
 Hrs. Water Maint. Man-2 at \$  
 Hrs. Garage Foreman at \$  
 Hrs. Labor at \$  
 Hrs. Compressor at \$  
 Compensation Ins. at \$ per C \$  
 Trucking \$  
 Pav't Patch \$  
Tap by Gifford & Co \$  
6 - - 68. \$  
 O'head \$

St. Pearl  
 Pt. 15  
 Ave. No. 15  
 Name of Owner New Bldg. Boy Scouts of Amer.

Labor and Mat'l. Report June 1968

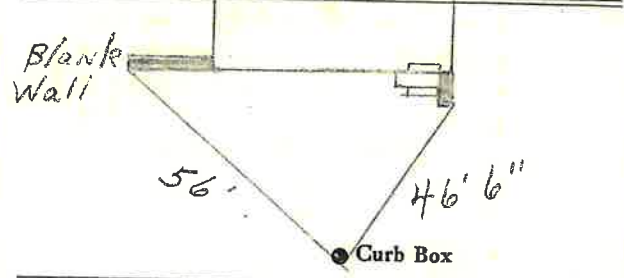

8" 1968 Main Elev. of Main at tap 5'  
 Gate at ● Gate at ●

● Curb Box  
 TAX ID# 303,17-10-19