

Labor and Materials

Copper } Connection.....	3	\$ 2.70
Lead }.....		
Curb } Cock Valve }..... in.....	3	\$ 2.39
} T. S. & V. }.....		
Service Box } Short 3 1/2 x 4 1/2 }.....	2	\$ 1.45
Old returned } Long 4 1/2 x 5 1/2 }.....		
} Buff. or Rdway }.....		
21 Ft. 3/4 in. } Copper } Pipe at.....	9	\$ 5.13
} Galv. Iron }.....		
} Cast Iron }.....	4	
Nipples..... in. at.....		\$
Bushings..... to..... in. at.....		\$
Red'g } Couplings..... to..... in. at.....		\$
Inc'g }.....		\$
Union..... in. at.....		\$
Meter..... in. at.....		\$
Lbs. Br. Stone at.....		\$
Lbs. Sand at.....		\$
Bags Cement 'at.....		\$
Paving Brick } Mack } at.....		\$
} Red }.....		\$
} Asphalt }.....		\$
Lead Joints at.....		\$
Leadite Joints at.....		\$
5 Hrs. Foreman at.....		\$ 3.12
18 Hrs. Common Labor at.....		\$ 8.10
Hrs. Common Labor at.....		\$
Hrs. Mason at.....		\$
Hrs. Mason's Helper at.....		\$
Hrs. Compressor at.....		\$
Compensation Ins.....		\$ 35
Trucking.....		\$ 1.-
Builders' Use of Water.....	Patch	\$ 5.-
Total \$		29.24

30-73

Labor and Material Report

July 11 1930

15 Pearl Street

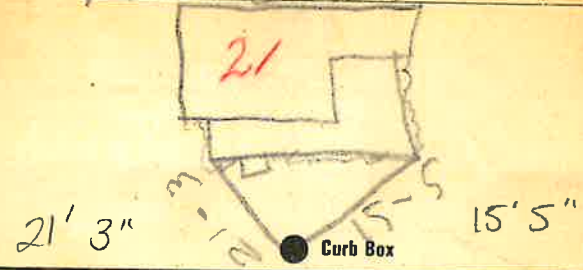

8" C.I. 1968
 Main Galv. Iron Elev of Main at tap 5
 Gate at ● Gate at ●

● Curb Box
 old lead disconnected

TAX ID # 363.17-10-15