

LABOR AND MATERIALS

1	Copper Lead	Connection	2"	\$
1	Curb	Cock Valve T.S. & V.	2 in. ORISEAL	\$
1	Service box Old returned	Short 3 1/2 x 4 1/2 Long 4 1/2 x 5 1/2 Buff or Rdway	ORISEAL	\$
12	Ft. 2 in.	Copper C.I. C.I.	Pipe at	\$
	Nipples	in. at		\$
	Bushings	to in. at		\$
	Red'g Inc'g	Coupl'gs	to in. at	\$
	Union	in. at		\$
	Meter	in. at		\$
1	Lead Joints at	Service CLAMP		\$
	Compound Joints at			\$
	Maintenance Foreman			\$
	Hrs. Water Maint. Man-1 at			\$
	Hrs. Water Maint. Man-2 at			\$
	Hrs. Garage Foreman at			\$
	Hrs. Labor at			\$
	Hrs. Compressor at			\$
	Compensation Ins. at \$	per C		\$
	Trucking			\$
	Pav't Patch			\$
	Tap Made By	Peck & Co		\$
	O'head	NOV 29-1972		\$

Peck

Ave. No. 14

Name of Owner VALCOUR
IMPRINTED PAPERS INC

Labor and Mat'l. Report NOV 29 1972

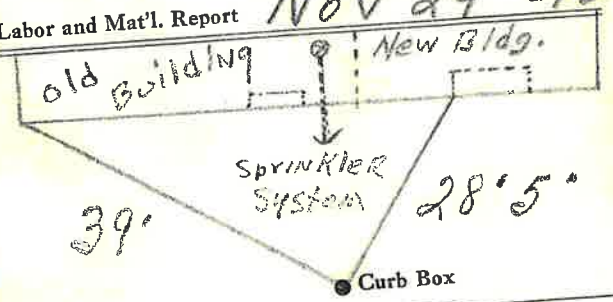

6" Main

Elev. of Main at tap 4'

Gate at •

• Gate at

• Curb Box

LABOR AND MATERIALS

1 Copper } Connection 1" \$
 Lead }
 1 Curb } Cock } 1 in. \$
 Valve }
 T.S. & V. }
 1 Service box { Short 3 1/2 x 4 1/2 }
 Old returned { Long 4 1/2 x 5 1/2 } \$
 { Buff or Rdway }
 14 Ft. 1 in. { Copper } Pipe at \$
 { G. I. }
 { C. I. }
 Nipples in. at \$
 Bushings to in. at \$
 Red'g }
 Inc'g } Coupl'gs to in. at \$
 Union in. at \$
 Meter in. at \$
 Lead Joints at \$
 Compound Joints at \$
 Maintenance Foreman \$
 Hrs. Water Maint. Man-1 at \$
 Hrs. Water Maint. Man-2 at \$
 Hrs. Garage Foreman at \$
 Hrs. Labor at \$
 Hrs. Compressor at \$
 Compensation Ins. at \$ per C \$
 Trucking \$
 Pay't Patch \$
 Tap Made By Peck & Co \$
 O'head 9-7-1972 \$
 \$

Peck Ave. No. 14
 Name of Owner Paper Inc.
 VALCOUR Imprinted

Labor and Mat'l. Report Sept. 7 1972

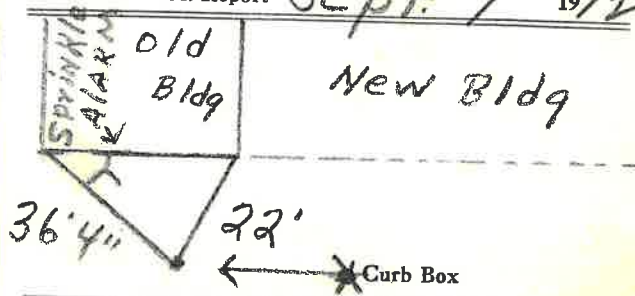

6" Main Elev. of Main at tap 4'
 Gate at • Gate at

• Curb Box