

LABOR AND MATERIALS

Copper	} Connection		\$			
Lead			\$			
Curb	} Cock Valve } T. S. & V.	} in.	\$			
				/ Service box	} Short 3 1/2 x 4 1/2	\$
		} Buff or Rdway	\$			
Ft.	} in.	} Copper G. I. C. I.	} Pipe at	\$		
Nipples					in. at	\$
Bushings					to in. at	\$
Red'g	} Coupl'gs	} to in. at	\$			
Inc'g						
Union	in. at	\$				
Meter	in. at	\$				
Lead Joints	at	\$				
Compound Joints	at	\$				
Maintenance Foreman		\$				
Hrs. Water Maint. Man-1	at	\$				
Hrs. Water Maint. Man-2	at	\$				
Hrs. Garage Foreman	at	\$				
Hrs. Labor	at	\$				
Hrs. Compressor	at	\$				
Compensation Ins. at \$	per C	\$				
Trucking		\$				
Pav't Patch		\$				
		\$				
		\$				
		\$				
O'head		\$				
		\$				

Peck Ave St. Pl. Ave. No. 17

Name of Owner
Humbly Oil Co Esso

Measured in June 30 1957

Labor and Mat'l. Report

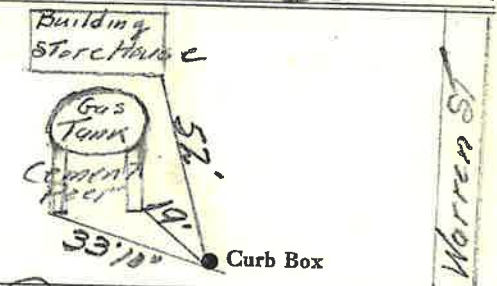

Peck Ave

6" Main Elev. of Main at tap 4 1/2"

Gate at • Gate at

• Curb Box