

LABOR AND MATERIALS

1	Copper Lead	Connection	3/4		\$ 1.23
1	Curb	Cock Valve	3/4 in.		\$ 1.68
		F. S. & V.			
1	Service Box Old returned	Short 3/2 x 4 1/2			\$ 1.54
		Long 4 1/2 x 5 1/2			
		Buff. on Railway			
20	Ft.	3/4 in.		Copper Galv Iron Cast Iron	Pipe at 17 \$ 3.40
	Nipples	in. at			\$
	Bushings	to in. at			\$
	Red'g Inc'g	Couplings	to in. at		\$
	Union	in. at			\$
	Meter	in. at			\$
	Lead Joints	at			\$
	Leadite Joints	at			\$
	Hrs. Foreman	at			\$
3	Hrs. Chauffeur	at	6 1/2		\$ 1.88
5	Hrs. Tapper	at	2		\$ 3.12
6	Hrs. Labor	at	45		\$ 2.70
	Hrs. Labor	at			\$
	Hrs. Compressor	at			\$
	Compensation Ins.				\$.24
	Trucking				\$ 1
	Builders Use of Water	no patch			\$
	Tap by Hoessel				\$
					\$
					\$
					\$
					\$
					\$
					\$ 16.79

27 - 1939

St.

Pl.

Ave. No. 3

Pine

Name of Owner

Hester Spier

Labor and Mat'l. Report

May 20 1939

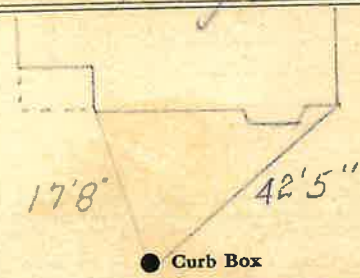

● Curb Box

6" Main

Elev. of Main at tap 5'

Gate at ●

● Gate at

TAX ID# 302.20-22-6

● Curb Box

old sheet of pipe labor charges