

LABOR AND MATERIALS

1 Copper } Connection $\frac{3}{4}$ " \$
 Lead }
 1 Curb } Cock } $\frac{3}{4}$ in. Oriseal. \$
 } Valve }
 } T.S. & V. }
 1 Service box { Short $3\frac{1}{2}$ x $4\frac{1}{2}$ }
 Old returned { Long $4\frac{1}{2}$ x $5\frac{1}{2}$ } \$
 } Buff. or Rdway }
 28 Ft $\frac{3}{4}$ in. { Copper } Pipe at \$
 } C.I. }
 } C.I. }
 Nipples in. at \$
 Bushings to in. at \$
 Red'g }
 Inc'g } Coupl'gs to in. at \$
 Union in. at \$
 Meter in. at \$
 Lead Joints at \$
 Compound Joints at \$
 Maintenance Foreman \$
 Hrs. Water Maint. Man-1 at \$
 Hrs. Water Maint. Man-2 at \$
 Hrs. Garage Foreman at \$
 Hrs. Labor at \$
 Hrs. Compressor at \$
 Compensation Ins. at \$ per C \$
 Trucking \$
 Pav't Patch \$
 Tap by Donovan, Lapeau & Co. \$
 10-20-69. \$
 O'head \$

Pine

St. ~~Pl.~~
 Ave. No. 25

Name of Owner
 D. Frank Sullivan

Labor and Mat'l. Report Oct. 20 1969

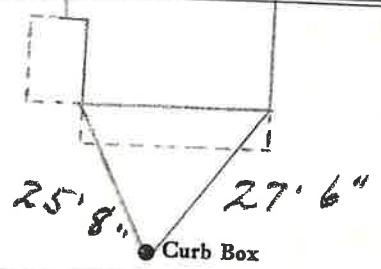

6" Main

Elev. of Main at tap 5'

Gate at • Gate at •

TAX ID# 309.27-4-4.2

• Curb Box