

LABOR AND MATERIALS

1 Copper } Connection 3/4 \$ 1.35
 Lead }
 1 Curb } Cock } 3/4 in. \$ 1.80
 Valve } T.S. & V. }
 1 Service Box } Short 3 3/4 x 4 1/2 }
 Old returned } Long 4 1/2 x 5 1/2 } \$ 1.70
 Buff for Rdway }
 26 Ft. 3/4 in. } Copper } Pipe at 18 \$ 4.68
 Galv. Iron }
 Cast Iron }
 Nipples in. at \$
 Bushings to in. at \$
 Red'g } Couplings to in. at \$
 Inc'g }
 Union in. at \$
 Meter in. at \$
 Lead Joints at \$
 Leadite Joints at \$
 Hrs. Foreman at \$
 3 Hrs. Chauffeur at 6 1/2 \$ 1.88
 8 1/2 Hrs. Tapper at \$ 5.31
 12 1/2 Hrs. Labor at 45 \$ 5.63
 Hrs. Labor at \$
 3/4 Hrs. Compressor at 6 1/2 \$ 46
 Compensation Ins. \$ 39
 Trucking \$ 1
 Builders Use of Water Before Paving \$
 Tapped by Hessel \$
 \$ 24.20

Y O I 1941

St. 27
 Pt. 23
 Ave. No 23

Platt

Name of Owner

Kennedy

Labor and Mat'l Report July 16 1941

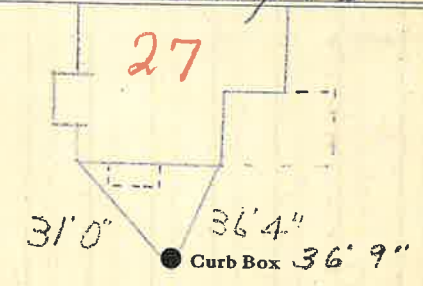

4 Main Elev. of Main at tap. 5

Gate at ● Gate at ●

TAX ID# 303.18-7-20

● Curb Box