

LABOR AND MATERIALS

1	Copper } Connection	3/4		\$ 1.35
	Lead			
1	Curb } Cock Valve T. S. & V.	3/4	in.	\$ 1.80
1	Service Box Old returned	Short 3 1/2 x 4 1/2 Long 4 1/2 x 5 1/2 Buff or Rdway		\$ 1.70
25	Ft. } in.	3/4	Copper Galv Iron Cast Iron	Pipe at 18 \$ 4.50
	Nipples			\$
	Bushings			\$
	Red'g } Inc'g			\$
	Union			\$
	Meter			\$
	Lead Joints at			\$
	Leadite Joints at			\$
	Hrs. Foreman at			\$
3	Hrs. Chauffeur at	6 1/2		\$ 1.88
	Hrs. Tapper at			\$
8	Hrs. Labor at	45		\$ 3.60
	Hrs. Labor at			\$
	Hrs. Compressor at			\$
	Compensation ins.			\$ 17
	Trucking			\$ 1
	Builders Use of Water	1/2 Patch (Sewer)		\$ 2.50
	<i>Apply Penec.</i>			\$
				\$
				\$
				\$
				\$
				\$ 18.50

41 1941

St. 29
Pl.
Ave. No. 25

Name of Owner Platt
Ed Kennedy

Labor and Mat'l. Report June 13 1941

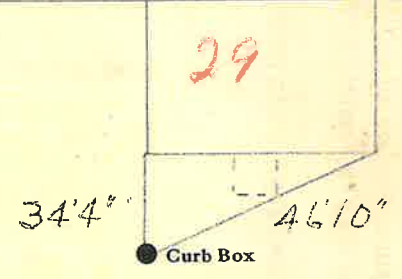

6 Main Elev. of Main at tap. 6

Gate at ● ● Gate at

TAX ID# 303.18-7-19

● Curb Box