

### LABOR AND MATERIALS

Copper Lead	} Connection	<u>3/4</u>		\$ <u>1.35</u>
1 Curb	} Cock Valve T. S. & V.	<u>3/4</u>	in.	\$ <u>1.80</u>
Service Box Old returned	} Short 3 1/2 x 4 1/2 Long 4 1/2 x 5 1/2 Buffer Rdway	} Same \$ <u>—</u>		
27 Ft.	} Copper Galv-Iron Cast-Iron	<u>3/4</u>	in. Pipe at	\$ <u>4.86</u>
Nipples	in. at			\$
Bushings	to in. at			\$
Red'g Inc'g	} Couplings to in. at			\$
Union	in. at			\$
Meter	in. at			\$
Lead Joints	at			\$
Leadite Joints	at			\$
Hrs. Foreman	at			\$
3 Hrs. Chauffeur	at	<u>6.2 1/2</u>		\$ <u>1.88</u>
8 1/2 Hrs. Tapper	at			\$ <u>5.31</u>
12 1/2 Hrs. Labor	at	<u>45</u>		\$ <u>5.63</u>
Hrs. Labor	at			\$
3 1/4 Hrs. Compressor	at	<u>6.7 1/2</u>		\$ <u>46</u>
Compensation Ins.				\$ <u>39</u>
Trucking				\$ <u>1.1</u>
Builders Use of Water	<u>By leaving</u>			\$ <u>—</u>
				\$ <u>22.68</u>

170-2 1941  
1331

St. 33  
Ave. No. 29

Platt

Name of Owner

McAvey

Labor and Mat'l. Report

July 19 1941

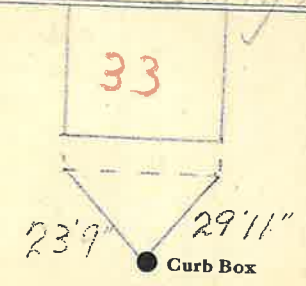

6 Main

Elev. of  
Main at tap 5

Gate at ●

● Gate at

TAX ID# 303.18-7-17

● Curb Box