

### LABOR AND MATERIALS

Copper Lead	} Connection	3/4		\$ 1.35
1 Curb	} Cock Valve T. S. & V.	3/4	in.	\$ 1.80
Service Box Old returned	} Short 3 1/2 x 4 1/2 Long 4 1/2 x 5 1/2 Buffer Rdway	Same \$ —		
9 Ft. 3/4	} Copper Galv. Iron. Cast Iron	3/4	in.	Pipe at 18 \$ 1.62
Nipples	..... in. at	\$		
Bushings	..... to ..... in. at	\$		
Red'g Inc'g	} Couplings ..... to ..... in. at	\$		
Union	..... in. at	\$		
Meter	..... in. at	\$		
Lead Joints at	.....	\$		
Leadite Joints at	.....	\$		
Hrs. Foreman at	.....	\$		
1 Hrs. Chauffeur at	..... 6 1/2	\$ 62		
3 Hrs. Tapper at	.....	\$ 1.88		
4 Hrs. Labor at	..... 45	\$ 1.80		
Hrs. Labor at	.....	\$		
3/4 Hrs. Compressor at	..... 6 1/2	\$ 46		
Compensation Ins.	.....	\$ 14		
Trucking	.....	\$ 1		
Builders Use of Water	Blue Ribbon	\$		
Taping Hose	.....	\$		
		\$		
		\$		
		\$		
		\$		
		\$ 10.67		

1 1 1 1941

Platt

St. 58  
Pl.   
Ave. No. 46

Name of Owner Casey

Labor and Mat'l. Report July 26 1941

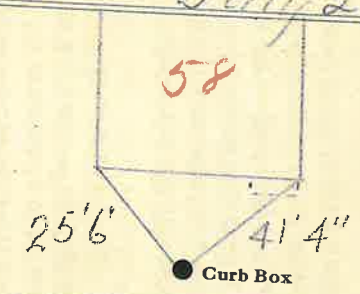

6 Main Elev. of Main at tap 5

Gate at ● ● Gate at

TAX ID # 303.18-1-1

● Curb Box