

LABOR AND MATERIALS

1	Copper	} Connection	3/4"	\$
1	Lead			
1	Curb	} Cock Valve T.S. & V.	3/4" in.	\$
1	Service box			
Old returned				
			Short 3 1/2 x 4 1/2	\$
			Long 4 1/2 x 5 1/2	
14	Ft.	} Copper G.I. G.I.	3/4" in.	\$
	Nipples	in. at		\$
	Bushings	to in. at		\$
	Red'g Inc'g	} Coupl'gs	to in. at	\$
	Union	in. at		\$
	Meter	in. at		\$
	Lead Joints	at		\$
	Compound Joints	at		\$
	Maintenance Foreman			\$
	Hrs. Water Maint. Man-1	at		\$
	Hrs. Water Maint. Man-2	at		\$
	Hrs. Garage Foreman	at		\$
	Hrs. Labor	at		\$
	Hrs. Compressor	at		\$
	Compensation Ins.	at \$	per C	\$
	Trucking			\$
	Pav't Patch			\$
	<i>Tap by Donovan & Co.</i>			
	<i>7-11-69.</i>			
	O'head			\$
				\$

Platt St. Ave. No. 85

Name of Owner Keege

Labor and Mat'l. Report July 11 1969

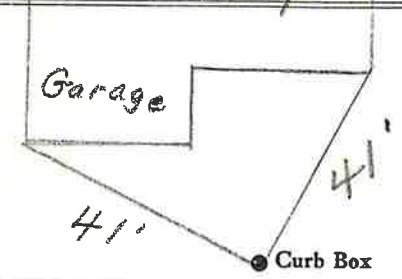

4" Main Elev. of Main at tap 4'

Gate at • Gate at •

TAX ID # 303.14-3-29

• Curb Box