

### Labor and Materials

Copper } Connection.....		\$ 1.46
-Lead } }		
Curb } Cock Valve } .....	in .....	\$ 1.93
.....	T.S. & V. }	
Service Box } Short 3 1/2 x 4 1/2 } .....		\$ 1.77
Old returned } Long 4 1/2 x 5 1/2 } .....		
.....	Buff. or Rdway }	
23 Ft. .... in.	{ Copper Galv Iron Cast Iron }	Pipe at ..... \$ 5.06
Nipples .....	in. at .....	\$ .....
Bushings .....	to .....	in. at .....
Red'g Inc'g } Conplings.....	to .....	in. at .....
Union .....	in. at .....	\$ .....
Meter .....	in. at .....	\$ .....
Lead Joints at .....		\$ .....
Leadite Joints at .....		\$ .....
Hrs. Foreman at .....		\$ .....
4 Hrs. Chauffeur at	6 1/2 hr	\$ 2.50
11 Hrs. Tapper at	6 1/2 hr	\$ 6.88
Hrs. Labor at .....		\$ .....
10 Hrs. Labor at	45	\$ 4.50
Hrs. Compressor at .....		\$ .....
Compensation Ins. .....		\$ 43
Trucking .....		\$ 1.00
Builders Use of Water	Patch (D.C.)	\$ 10.00
Tapping .....		\$ .....
.....		\$ .....
.....		\$ .....
.....		\$ .....
.....		\$ 35.53

108-1937

Platt St.

St. 99  
Pl. 68  
Ave. No.

Name of Owner

Lamoy

Labor and Mat'l. Report

for

22 1937

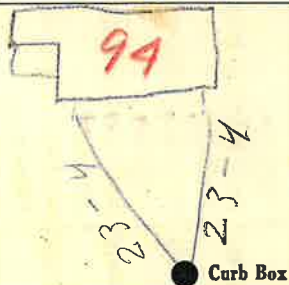

Main Iron Main

Elev. of Main at tap

Gate at

Gate at

TAX ID# 303.14-2-5

Curb Box

Old tap disconnected