

LABOR AND MATERIALS

1	Copper Lead	Connection	1"	\$	
1	Curb	Cock Valve T.S. & V.	1 in.	\$	
1	Service box Old returned	Short 3½ x 4½ Long 4½ x 5½ Buff or Rdway	Cut off to 39"	\$	
85	Ft. 1 in.	Copper G.I. G.I.	Pipe at	\$	
	Nipples	in. at		\$	
	Bushings	to in. at		\$	
	Red'g Inc'g	Coupl'gs to in. at		\$	
	Union	in. at		\$	
	Meter	in. at		\$	
	Lead Joints	at		\$	
	Compound Joints	at		\$	
	Maintenance Foreman			\$	
	Hrs. Water Maint. Man-1	at		\$	
	Hrs. Water Maint. Man-2	at		\$	
	Hrs. Garage Foreman	at		\$	
	Hrs. Labor	at		\$	
	Hrs. Compressor	at		\$	
	Compensation Ins.	at \$ per C		\$	
	Trucking			\$	
	Pav't Patch			\$	
	Tap by Miller & Co			\$	
	9-10-52.			\$	
	O'head			\$	

Upper Platt St. PL Ave. No.

Name of Owner

Labor and Mat'l. Report Sept. 10 1952

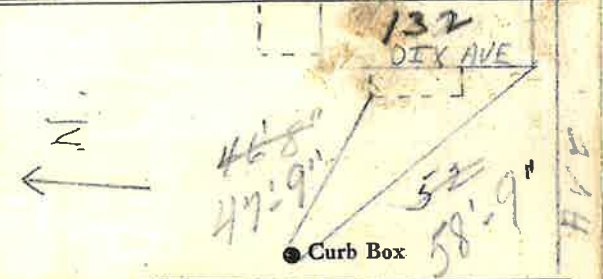

Upper Platt St.

6" Main Elev. of Main at tap 5'

Gate at • Gate at

TAX ID# 303.14-1-9

Shut off for 1" Line for Upper Platt St. measured from 132 Dix Ave.