

LABOR AND MATERIALS

Copper	} Connection	_____	\$ _____		
Lead					
Curb	} Cock Valve T. S. & V.	} _____ in.	\$ _____		
Service box	} Short 3 1/2 x 4 1/2 Long 4 1/2 x 5 1/2 Buff or Rdway	} _____	\$ _____		
Old returned					
Ft. _____ in.	} Copper G. I. C. I.	} Pipe at _____	\$ _____		
Nipples _____ in.	at _____	\$ _____			
Bushings _____ to _____ in.	at _____	\$ _____			
Red'g Inc'g } Coupl'gs _____ to _____ in.	at _____	\$ _____			
Union _____ in.	at _____	\$ _____			
Meter _____ in.	at _____	\$ _____			
Lead Joints at _____		\$ _____			
Compound Joints at _____		\$ _____			
Maintenance Foreman _____		\$ _____			
Hrs. Water Maint. Man-1 at _____		\$ _____			
Hrs. Water Maint. Man-2 at _____		\$ _____			
Hrs. Garage Foreman _____ at _____		\$ _____			
Hrs. Labor _____ at _____		\$ _____			
Hrs. Compressor at _____		\$ _____			
Compensation Ins. at \$ _____ per C _____		\$ _____			
Trucking _____		\$ _____			
Pav't Patch _____		\$ _____			
		\$ _____			
		\$ _____			
O'head _____		\$ _____			

LAST HOUSE ON UPPER PLATT
 (148 DIX - IN COMPUTER) Str. No. 138
 PLATT ST EXTEN Ave. No. _____
 Name of Owner
 FREDELLA (TENANT-ASHE)
 MEASURED IN 8-1-1972
 Labor and Mat'l. Report

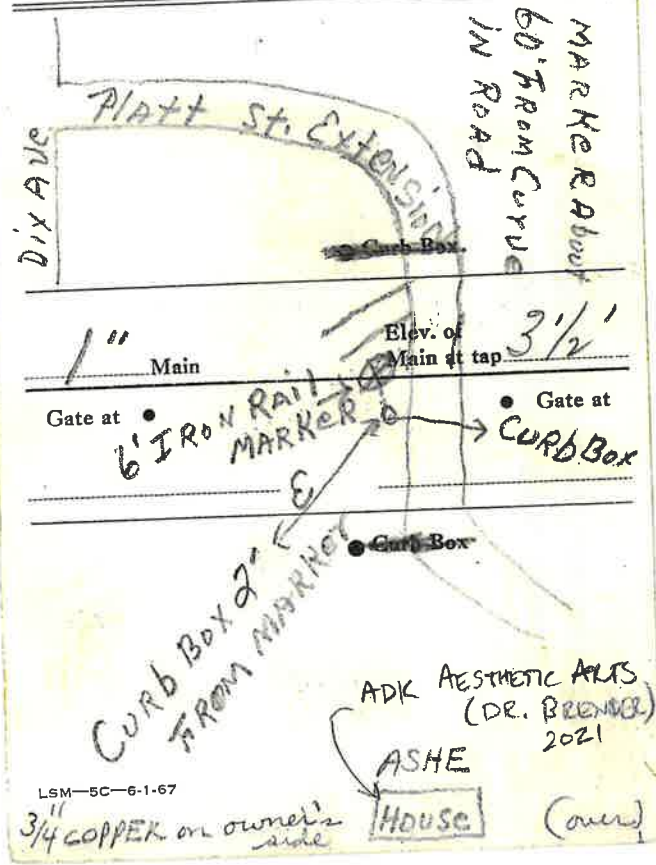

This property is called 148 Dix ave in Computer

LSM-5C-6-1-67

ADK AESTHETIC ARTS (DR. BREWER) 2021
 ASHE HOUSE (over)
 3/4" COPPER on owner's side